

# JVC



## AUDIO/VIDEO CONTROL RECEIVER

# RX-7032VSL

**AV COMPU LINK**

**COMPU LINK**  
Remote

**DOLBY**  
DIGITAL EX  
PRO LOGIC II

**dts** 96 ES  
24 NEOS

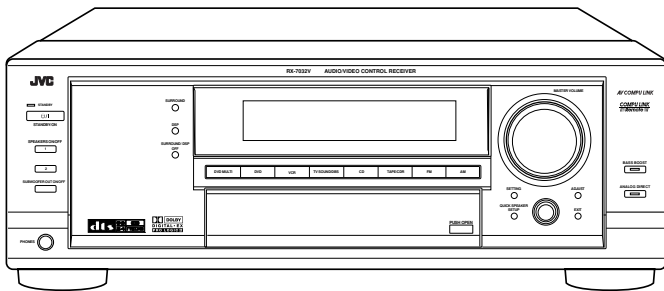

## INSTRUCTIONS

**For Customer Use:**

Enter below the Model No. and Serial No. which are located either on the rear, bottom or side of the cabinet. Retain this information for future reference.

Model No. \_\_\_\_\_

Serial No. \_\_\_\_\_

LVT1007-010A[A]

# Warnings, Cautions and Others

## Caution — $\phi$ /I STANDBY/ON switch!

Disconnect the mains plug to shut the power off completely. The  $\phi$ /I STANDBY/ON switch in any position does not disconnect the mains line. The power can be remote controlled.

## CAUTION

To reduce the risk of electrical shocks, fire, etc.:

1. Do not remove screws, covers or cabinet.
2. Do not expose this appliance to rain or moisture.

## CAUTION

- Do not block the ventilation openings or holes.  
(If the ventilation openings or holes are blocked by a newspaper or cloth, etc., the heat may not be able to get out.)
- Do not place any naked flame sources, such as lighted candles, on the apparatus.
- When discarding batteries, environmental problems must be considered and local rules or laws governing the disposal of these batteries must be followed strictly.
- Do not expose this apparatus to rain, moisture, dripping or splashing and that no objects filled with liquids, such as vases, shall be placed on the apparatus.

## Caution: Proper Ventilation

To avoid risk of electric shock and fire and to protect from damage.

Locate the apparatus as follows:

- Front: No obstructions open spacing.  
Sides: No obstructions in 10 cm from the sides.  
Top: No obstructions in 10 cm from the top.  
Back: No obstructions in 15 cm from the back.  
Bottom: No obstructions, place on the level surface.

In addition, maintain the best possible air circulation as illustrated.

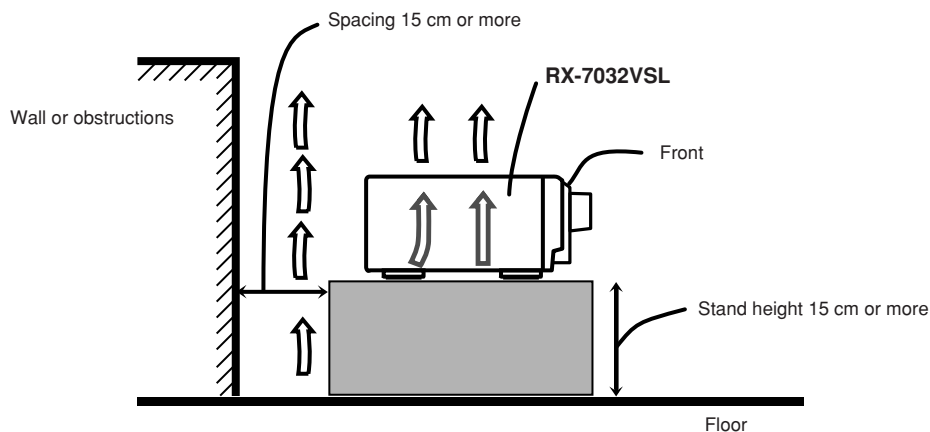

# Table of Contents

<b>Introduction</b> .....	<b>2</b>	<b>Adjusting Sound</b> .....	<b>29</b>
<b>Parts Identification</b> .....	<b>3</b>	Basic Setting Items .....	29
Remote Control .....	3	Basic Procedure .....	29
Front Panel .....	4	Adjusting the Equalization Patterns .....	30
Rear Panel .....	6	Adjusting the Speaker Output Levels .....	30
<b>Getting Started</b> .....	<b>7</b>	Adjusting the Sound Parameters for the Surround and DSP modes .....	31
Before Installation .....	7	<b>Using the Surround Modes</b> .....	<b>32</b>
Checking the Supplied Accessories .....	7	Reproducing Theater Ambience .....	32
Putting Batteries in the Remote Control .....	7	Introducing the Surround Modes .....	32
Connecting the FM and AM Antennas .....	8	Surround Modes Applicable to the Various Software .....	34
Connecting the Speakers .....	9	Activating the Surround Modes .....	35
Connecting Audio/Video Components .....	11	■ Activating the EX/ES setting .....	35
■ Analog Connections .....	11	■ Activating the Surround Modes .....	35
■ Digital Connections .....	14	<b>Using the DSP Modes</b> .....	<b>36</b>
Connecting the Power Cord .....	14	Reproducing the Sound Field .....	36
<b>Basic Operations</b> .....	<b>15</b>	Introducing the DSP Modes .....	36
Daily Operational Procedure .....	15	Activating the DSP Modes .....	37
Turning On the Power .....	15	<b>Using the DVD MULTI Playback Mode</b> .....	<b>38</b>
Selecting the Source to Play .....	15	Activating the DVD MULTI Playback Mode .....	38
Adjusting the Volume .....	16	<b>COMPU LINK Remote Control System</b> .....	<b>39</b>
Selecting the Front Speakers .....	17	<b>AV COMPU LINK Remote Control System</b> ...	<b>40</b>
Activating and Adjusting the Subwoofer Sound .....	17	<b>Operating JVC's Audio/Video Components</b> ...	<b>42</b>
Selecting the Analog or Digital Input Mode .....	17	Operating Audio Components .....	42
Setting the Dynamic Range .....	18	Operating Video Components .....	44
Attenuating the Input Signal .....	18	<b>Operating Other Manufacturers' Video     Equipment</b> .....	<b>45</b>
Turning Analog Direct On and Off .....	19	<b>Troubleshooting</b> .....	<b>49</b>
Changing the Source Name .....	19	<b>Specifications</b> .....	<b>50</b>
Reinforcing the Bass .....	20		
Muting the Sound .....	20		
Changing the Display Brightness .....	20		
Using the Sleep Timer .....	20		
<b>Receiving Radio Broadcasts</b> .....	<b>21</b>		
Tuning in to Stations Manually .....	21		
Using Preset Tuning .....	21		
Selecting the FM Reception Mode .....	22		
<b>Basic Settings</b> .....	<b>23</b>		
Setting the Speakers Configuration .....	23		
Basic Setting Items .....	24		
Basic Procedure .....	25		
Setting the Speakers .....	25		
Setting the Speaker Distance .....	26		
Setting the Bass Sounds .....	27		
Selecting main or sub channel—DUAL MONO .....	27		
Setting the Digital Input Terminals .....	28		
Setting the Component Video Input .....	28		
Memorizing the Volume Level for Each Source .....	28		



This mark indicates that **ONLY** the remote control CAN be used for the operation explained.



This mark indicates that the remote control **CANNOT** be used for the operation explained. Use the buttons on the front panel.

# Introduction

*We would like to thank you for purchasing one of our JVC products.  
Before operating this unit, read this manual carefully and thoroughly to obtain the best possible performance  
from your unit, and retain this manual for future reference.*

## Features

### Compatible with various audio formats including DTS 96/24

RX-7032VSL allows you to enjoy a newly introduced audio format such as Dolby Digital EX, Dolby Pro Logic II, DTS-ES, DTS Neo:6, and DTS 96/24.

- This unit is also compatible with Dual Mono signals recorded in Dolby Digital and DTS discs.

### DAP (Digital Acoustic Processor)

Sound field simulation technology allows precise ambience recreation of existing theaters and halls. Thanks to the high-performance DSP (Digital Signal Processor) and high-capacity memory, you can enjoy multi-channel surround sound by playing 2-channel or multi-channel software according to the speaker setting.

### Multi-channel headphone virtual surround sound—3D HEADPHONE Mode

The built-in headphone virtual surround system is compatible with Multi-channel software like Dolby Digital, DTS Surround, etc. Thanks to the new signal processing algorithms used by the high-performance DSP, you can enjoy a natural surround sound through the headphones.

### COMPU LINK remote control system

The COMPU LINK remote control system allows you to operate other JVC audio/video components from this receiver.

## Precautions

### Power sources

- When unplugging the receiver from the wall outlet, always pull the plug, not the AC power cord.
- Do not handle the AC power cord with wet hands.
- If you are not going to operate the receiver for an extended period of time, unplug the AC power cord from the wall outlet.

### Ventilation

High power amplifiers built in this receiver will generate heat inside the cabinet. For safety, observe the following carefully.

- Make sure there is good ventilation around the receiver. Poor ventilation could overheat and damage the receiver.
- Do not block the ventilation openings or holes. (If the ventilation openings or holes are blocked by a newspaper or cloth, etc., the heat may not be able to get out.)

### Others

- Should any metallic object or liquid fall onto the unit, unplug the unit and consult your dealer before operating any further.
- Do not expose this apparatus to rain, moisture, dripping or splashing and that no objects filled with liquids, such as vases shall be placed on the apparatus.
- Do not disassemble the unit since there are no user serviceable parts inside.

If anything goes wrong, unplug the AC power cord and consult your JVC dealer.

# Parts Identification

## Remote Control

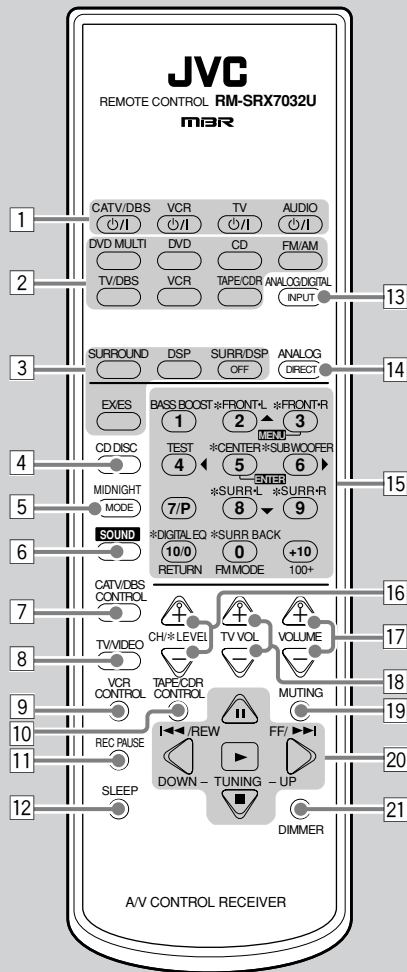

- 1  $\phi$ /I buttons (15, 44 – 48)  
CATV/DBS  $\phi$ /I, VCR  $\phi$ /I, TV  $\phi$ /I, AUDIO  $\phi$ /I
- 2 Source selection buttons (15, 16, 17, 21, 22, 35, 38)  
DVD MULTI, DVD, CD\*, FM/AM\*, TV/DBS, VCR, TAPE/CDR\*  
\* When you press one on these source selection buttons on the remote control, the receiver automatically turns on.
- 3
  - SURROUND button (35)
  - DSP button (37)
  - SURR (surround)/DSP OFF button (35, 37)
  - EX/ES button (35)
- 4 CD DISC button (43)
- 5 MIDNIGHT MODE button (18)
- 6 SOUND button (20, 30, 31)
- 7 CATV/DBS CONTROL button (46)
- 8 TV/VIDEO button (44, 45)
- 9 VCR CONTROL button (44)
- 10 TAPE/CDR CONTROL button (43)
- 11 REC PAUSE button (43, 44, 47)
- 12 SLEEP button (20)
- 13 ANALOG/DIGITAL INPUT button (18)
- 14 ANALOG DIRECT button (19)
- 15
  - 10 keys for operating the tuner (22)
  - 10 keys for adjusting sound (30, 31)
  - 10 keys for operating audio/video components (42 – 48)
- 16
  - CH (channel) +/- buttons (44 – 47)
  - \*LEVEL +/- buttons (30, 31, 42)  
*The LEVEL +/- buttons function only after pressing SOUND then 10 keys which are marked with an asterisk (\*) on the remote control.*
- 17 VOLUME +/- buttons (16)
- 18 TV VOL (volume) +/- buttons (44, 45)
- 19 MUTING button (20)
- 20
  - TUNING UP/DOWN buttons (21)  
• Operating buttons for audio/video components (42 – 44, 47, 48)  
▶, ■, ■, I-REW, FF▶▶I
- 21 DIMMER button (20)

## Front Panel

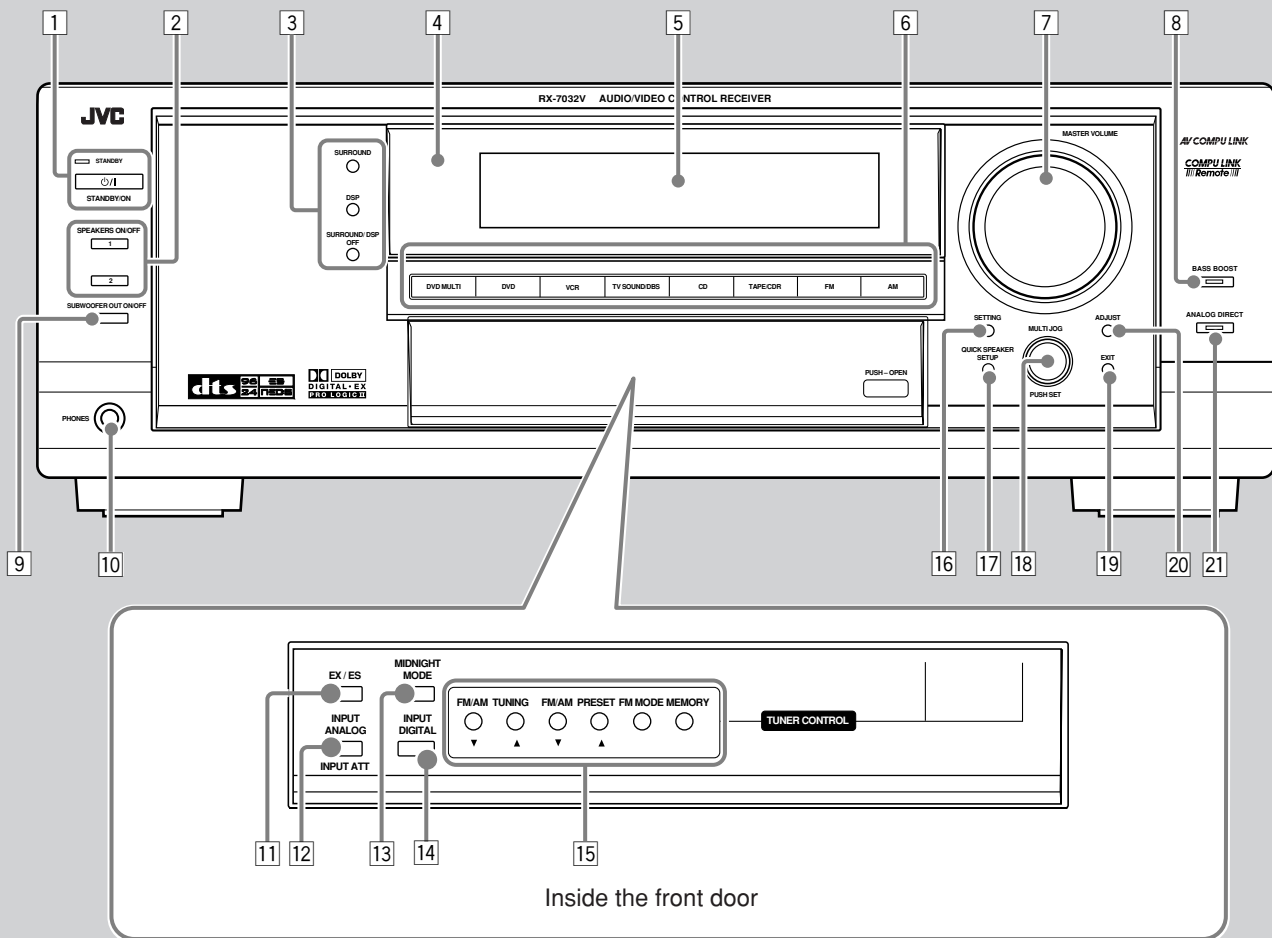

### Front Panel

- 1  $\phi$ /I/STANDBY/ON button and STANDBY lamp (15)
- 2 • SPEAKERS ON/OFF 1 button (17)  
• SPEAKERS ON/OFF 2 button (17)
- 3 • SURROUND button (35)  
• DSP button (37)  
• SURROUND/DSP OFF button (35, 37)
- 4 Remote sensor
- 5 Display window (15)
- 6 Source selection buttons (15, 16, 17, 19, 21, 22, 35, 38)  
DVD MULTI, DVD, VCR, TV SOUND/DBS, CD,  
TAPE/CDR, FM, AM
- 7 MASTER VOLUME control (16)
- 8 BASS BOOST button and lamp (20)
- 9 SUBWOOFER OUT ON/OFF button (17)
- 10 PHONES jack (17)
- 11 EX/ES button (35)
- 12 • INPUT ANALOG button (18)  
• INPUT ATT button (18)
- 13 MIDNIGHT MODE button (18)
- 14 INPUT DIGITAL button (18)
- 15 TUNER CONTROL buttons  
• FM/AM TUNING  $\blacktriangle$  /  $\blacktriangledown$  buttons (21)  
• FM/AM PRESET  $\blacktriangle$  /  $\blacktriangledown$  buttons (22)  
• FM MODE button (22)  
• MEMORY button (21)
- 16 SETTING button (25)
- 17 QUICK SPEAKER SETUP button (23)
- 18 • MULTI JOG control (23, 25, 29)  
• PUSH SET button (23, 25, 29)
- 19 EXIT button (25, 29)
- 20 ADJUST button (29)
- 21 ANALOG DIRECT button and lamp (19)

## Display Window

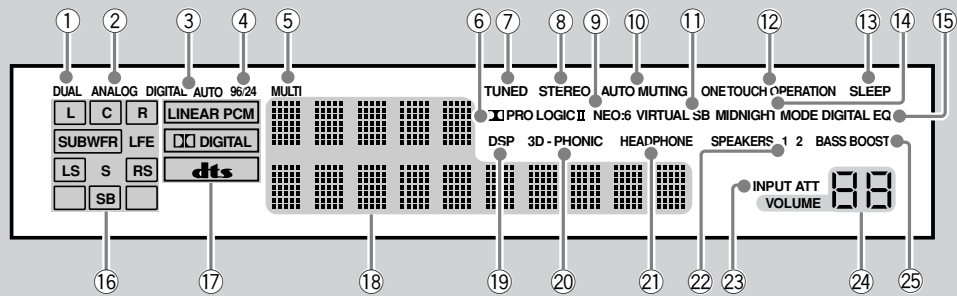

## Display Window

- |   |  |
|---|--|
| ① DUAL indicator (33)                           | ⑬ SLEEP indicator (20)                     |
| ② ANALOG indicator (18)                         | ⑭ MIDNIGHT MODE indicator (18)             |
| ③ DIGITAL AUTO indicator (18)                   | ⑮ DIGITAL EQ (equalization) indicator (30) |
| ④ 96/24 indicator (33)                          | ⑯ Speaker and signal indicators (16)       |
| ⑤ MULTI indicator (38)                          | ⑰ Digital signal format indicators (18)    |
| ⑥ •  PRO LOGIC indicator (32)                   | ⑱ DSP indicator (17, 36)                   |
| •  PRO LOGIC II indicator (33)                  | ⑳ 3D-PHONIC indicator (36)                 |
| ⑦ TUNED indicator (21)                          | ㉑ HEADPHONE indicator (17, 36)             |
| ⑧ STEREO indicator (21, 22)                     | ㉒ SPEAKERS 1/2 indicators (17)             |
| ⑨ NEO:6 indicator (33)                          | ㉓ INPUT ATT (attenuator) indicator (18)    |
| ⑩ AUTO MUTING indicator (22)                    | ㉔ VOLUME level indicator (15, 20)          |
| ⑪ VIRTUAL SB (Surround Back) indicator (32, 33) | ㉕ BASS BOOST indicator (20)                |
| ⑫ ONE TOUCH OPERATION indicator (28)            |  |

## How to open the front door

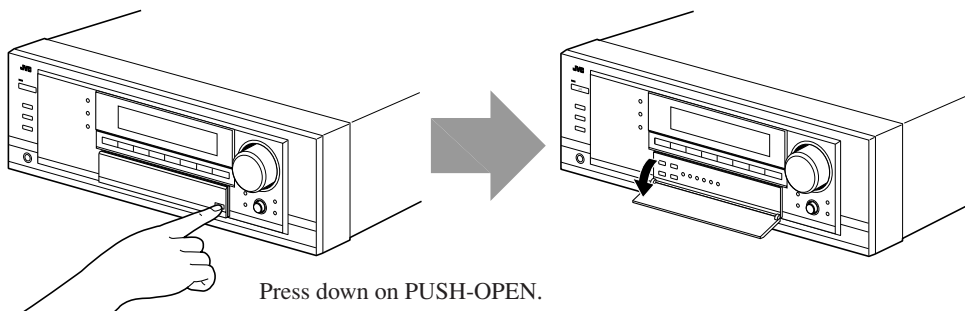

## Rear Panel

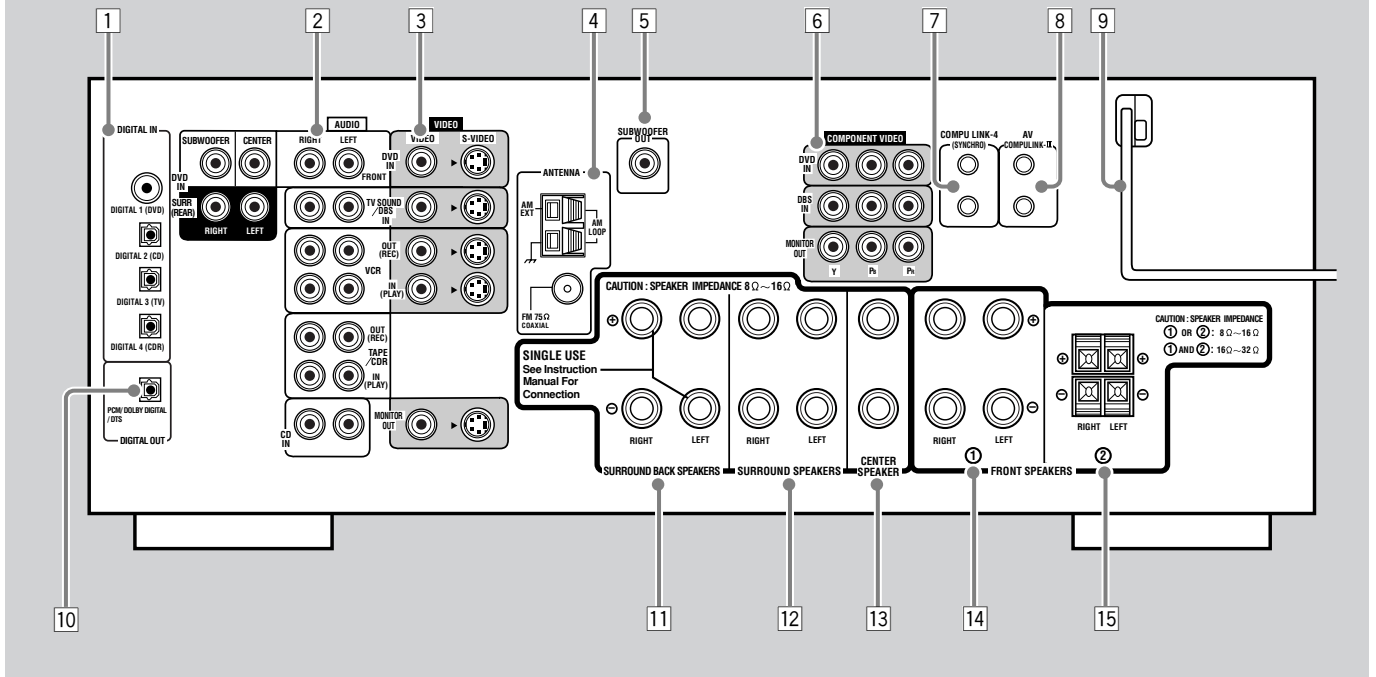

### Rear Panel

- 1 DIGITAL IN terminals (14)
  - Coaxial: DIGITAL 1 (DVD)
  - Optical: DIGITAL 2 (CD), DIGITAL 3 (TV), DIGITAL 4 (CDR)
- 2 AUDIO input/output jacks (11 – 13)
  - Input: DVD IN—FRONT, CENTER, SUBWOOFER, SURR (REAR), TV SOUND/DBS IN, VCR IN (PLAY), TAPE/CDR IN (PLAY), CD IN
  - Output: VCR OUT (REC), TAPE/CDR OUT (REC)
- 3 S-VIDEO and composite VIDEO input/output jacks (12, 13)
  - Input: DVD IN, TV SOUND/DBS IN, VCR IN (PLAY)
  - Output: VCR OUT (REC), MONITOR OUT
- 4 FM/AM ANTENNA terminals (8)
- 5 SUBWOOFER OUT jack (10)
- 6 COMPONENT VIDEO input/output jacks (12, 13)
  - Input: DVD IN, DBS IN
  - Output: MONITOR OUT
- 7 COMPU LINK-4 (SYNCHRO) terminals (39)
- 8 AV COMPULINK-III terminals (40)
- 9 AC power cord (14)
- 10 DIGITAL OUT terminal (14)
- 11 SURROUND BACK SPEAKERS terminals (10)
- 12 SURROUND SPEAKERS terminals (10)
- 13 CENTER SPEAKER terminals (10)
- 14 FRONT SPEAKERS ① terminals (10)
- 15 FRONT SPEAKERS ② terminals (10)



# Getting Started

This section explains how to connect audio/video components and speakers to the receiver, and how to connect the power supply.

## Before Installation

### General Precautions

- Be sure your hands are dry.
- Turn the power off to all components.
- Read the manuals supplied with the components you are going to connect.

### Locations

- Install the receiver in a location that is level and protected from moisture.
- The temperature around the receiver must be between  $-5^{\circ}\text{C}$  and  $35^{\circ}\text{C}$ .
- Make sure there is good ventilation around the receiver. Poor ventilation could cause overheating and damage the receiver.

### Handling the receiver

- Do not insert any metal object into the receiver.
- Do not disassemble the receiver or remove screws, covers, or cabinet.
- Do not expose the receiver to rain or moisture.

## Checking the Supplied Accessories

Check to be sure you have all of the following items, which are supplied with the receiver.

The number in the parentheses indicates quantity of the pieces supplied.

- Remote Control (1)
- Batteries (2)
- AM Loop Antenna (1)
- FM Antenna (1)

If anything is missing, contact your dealer immediately.

## Putting Batteries in the Remote Control

Before using the remote control, insert the two supplied batteries first.

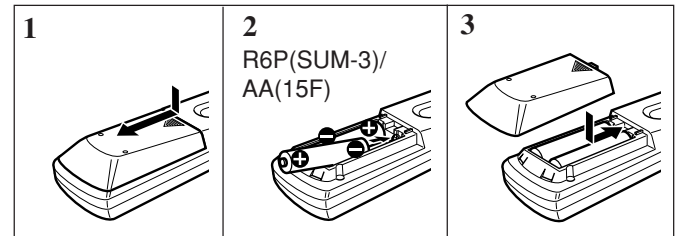

**1. Press and slide the battery cover on the back of the remote control.**

**2. Insert the batteries.**

- Make sure to match the polarity: (+) to (+) and (-) to (-).

**3. Replace the cover.**

If the remote control cannot transmit signals or operate the receiver correctly, replace the batteries. Use two R6P(SUM-3)/AA(15F) type dry-cell batteries.

### Notes:

- Supplied batteries are for the initial setup. Replace the batteries for continued use.
- After replacing the batteries, set the manufacturers' codes again (see pages 45 to 48).

### CAUTION:

Follow these precautions to avoid leaking or cracking cells:

- Place batteries in the remote control so they match the polarity: (+) to (+) and (-) to (-).
- Use the correct type of batteries. Batteries that look similar may differ in voltage.
- Always replace both batteries at the same time.
- Do not expose batteries to heat or flame.

## Connecting the FM and AM Antennas

### FM Antenna Connections

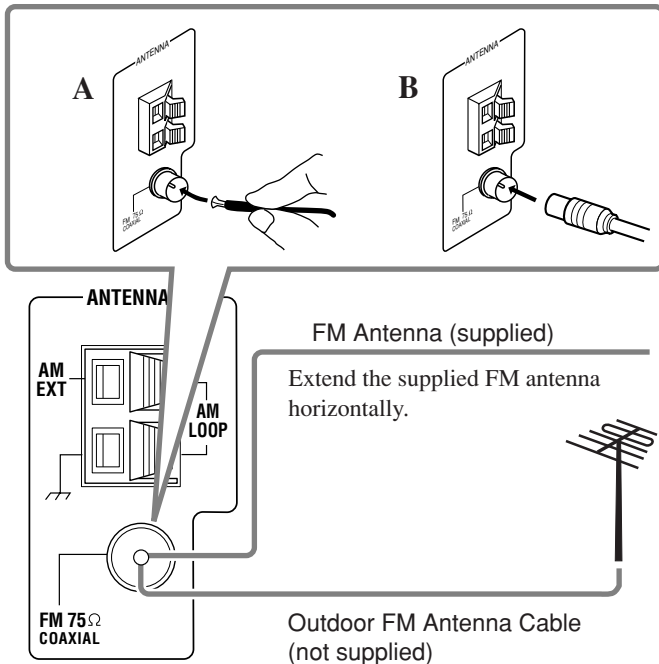

#### A. Using the Supplied FM Antenna

The FM antenna provided can be connected to the FM 75 Ω COAXIAL terminal as temporary measure.

#### B. Using the Standard Type Connector (Not Supplied)

A standard type connector should be connected to the FM 75 Ω COAXIAL terminal.

#### Note:

If reception is poor, connect the outdoor FM antenna (not supplied). Before attaching a 75 Ω coaxial cable with a standard-type connector (IEC or DIN 45325), disconnect the supplied FM antenna.

### AM Antenna Connections

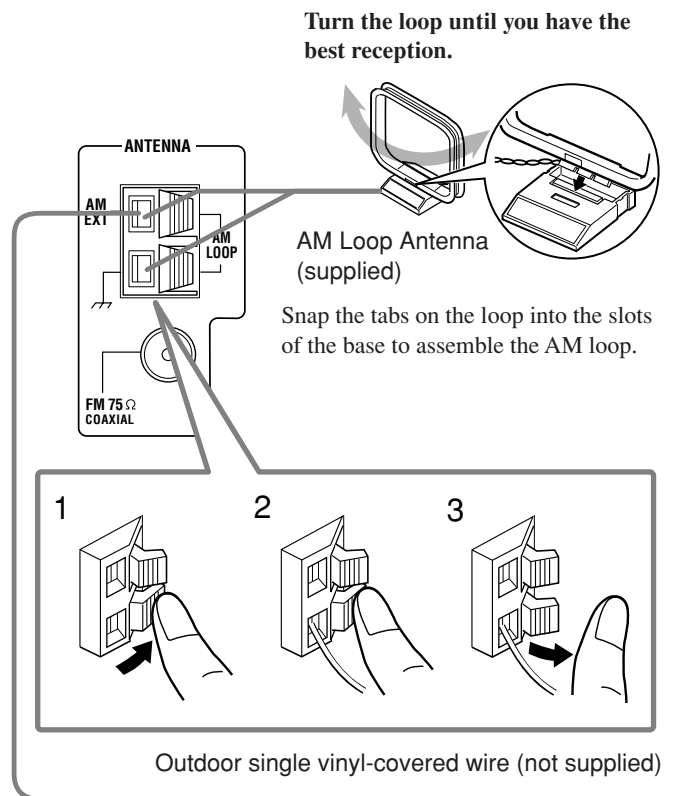

#### Notes:

- If the AM loop antenna wire is covered with vinyl, remove the vinyl by twisting it as illustrated.
- Make sure the antenna conductors do not touch any other terminals, connecting cords and power cord. This could cause poor reception.
- If reception is poor, connect an outdoor single vinyl-covered wire (not supplied) to the AM EXT terminal. (Keep the AM loop antenna connected.)

## Connecting the Speakers

You can connect the following speakers:

- Two pairs of front speakers to produce normal stereo sound.
- One pair of surround speakers to enjoy the surround effect.
- One surround back speaker or one pair of surround back speakers to enjoy to produce more effective surround effect.
- One center speaker to emphasize human voices.
- One subwoofer to enhance the bass.

### CAUTION:

Use only the speakers of the **SPEAKER IMPEDANCE** indicated by the speaker terminals.

- **When connecting to both of the FRONT SPEAKERS ① and ② terminals**, use speakers with an impedance of 16  $\Omega$  to 32  $\Omega$ .
- **When connecting to either the FRONT SPEAKERS ① or ② terminals**, use speakers with an impedance of 8  $\Omega$  to 16  $\Omega$ .

### Basic connecting procedure

**1 Twist and remove the insulation at the end of each speaker signal cable (not supplied).**

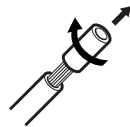

**2 Open the speaker terminal.**

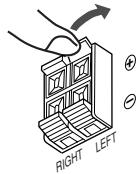
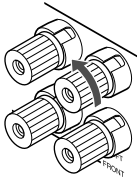

For FRONT SPEAKERS ② terminals

**3 Insert the speaker signal cable.**

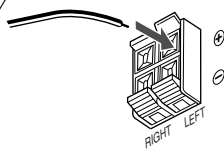
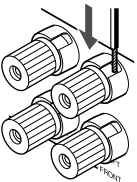

**4 Close the speaker terminal.**

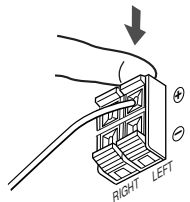
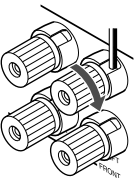

For each speaker (except for a subwoofer), connect the (+) and (-) terminals on the rear panel to the (+) and (-) terminals marked on the speakers.

### Speaker layout

Ideal speaker layout varies depending on the conditions of your listening room. The diagram below is a recommended typical example.

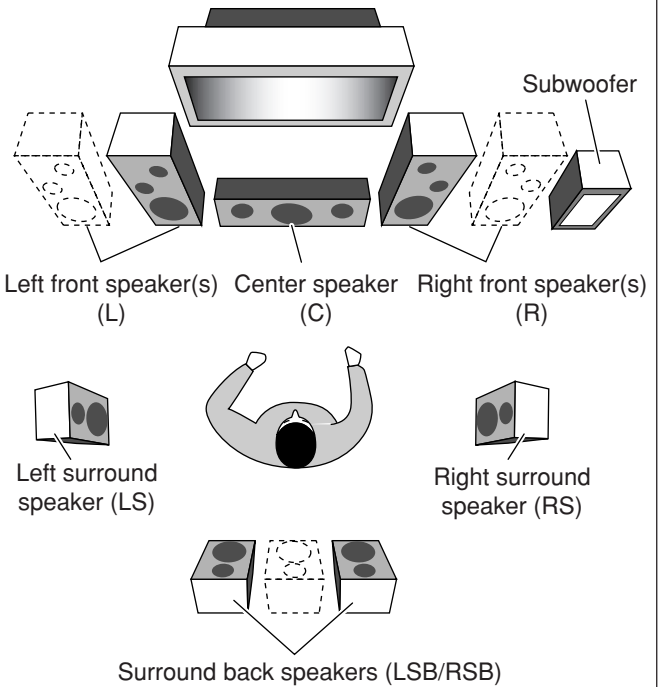

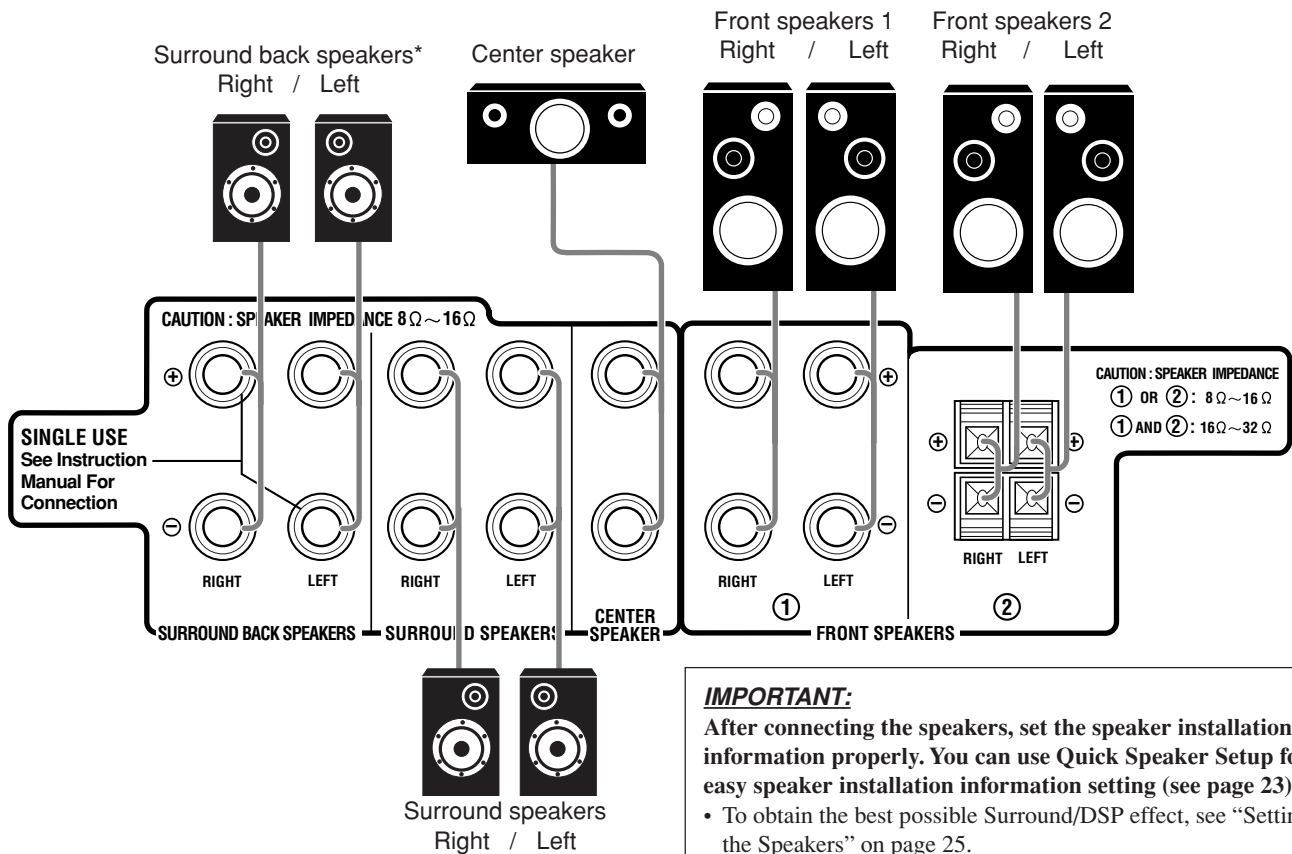

**IMPORTANT:**  
After connecting the speakers, set the speaker installation information properly. You can use Quick Speaker Setup for easy speaker installation information setting (see page 23).  
• To obtain the best possible Surround/DSP effect, see “Setting the Speakers” on page 25.

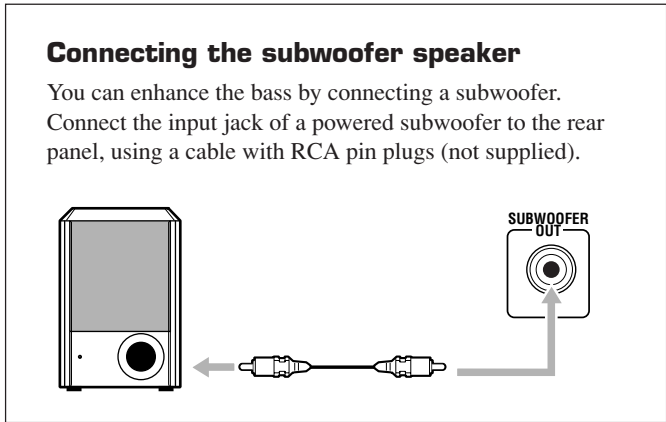
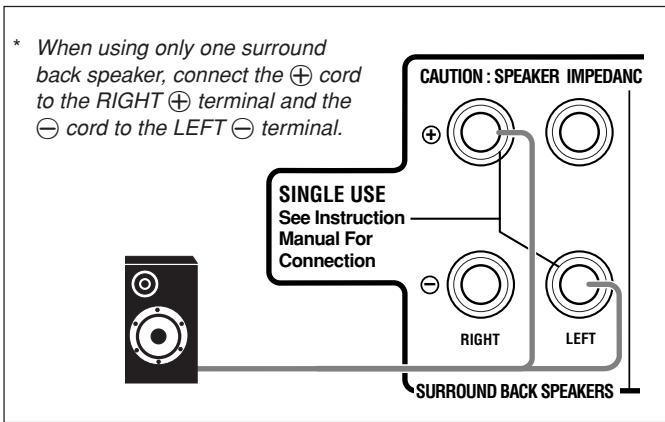

**Placing speakers**

**Front speakers and center speaker**

- Place these speakers (position of the mid-range speaker units) at the same height from the floor.
- Point these speakers aiming at the listener’s ears.

**Surround and surround back speakers**

- Place these speakers at a position which is 1 meter higher than the listener’s ears.
- Point these speakers down aiming at the listener’s ears.

**Subwoofer**

- You can place it wherever you like since bass sound is non-directional. Normally place it in front of you.

**Note:**

Ideal speaker layout requires that all speakers be placed at the same distance from the listener. However, since in some places it may be difficult to fulfil this requirement, this unit can adjust the delay time so that the sounds through all the speakers reach the listener with the same timing. (See page 26.)

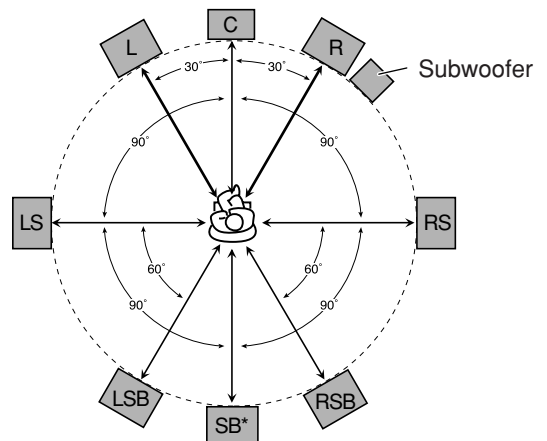

\* When one surround back speaker is connected.

## Connecting Audio/Video Components

When connecting individual components, refer also to the manuals supplied with them.

### ■ Analog Connections

If your audio components have digital audio output terminal, connecting them using the digital cords explained in "Digital Connections" (see page 14) will give you better sound quality.

#### Audio component connections

Use the cables with RCA pin plugs (not supplied).

- Connect the white plug to the audio left jack, and the red plug to the audio right jack.

#### **If your audio components have a COMPU LINK jack**

See also page 39 for detailed information about the connection and the COMPU LINK remote control system.

#### **CAUTION:**

If you connect a sound-enhancing device such as a graphic equalizer between the source components and this receiver, the sound output through this receiver may be distorted.

### CD player

To listen to the sound after connection, press CD.

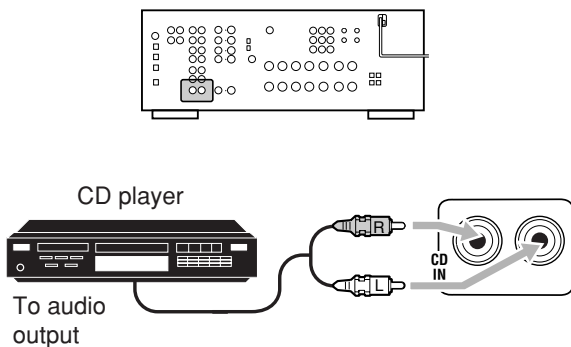

### Cassette deck

To listen to the sound after connection, press TAPE/CDR.

You can connect either a cassette deck or a CD recorder to the TAPE/CDR jacks. When connecting an CD recorder to the TAPE/CDR jacks, see below.

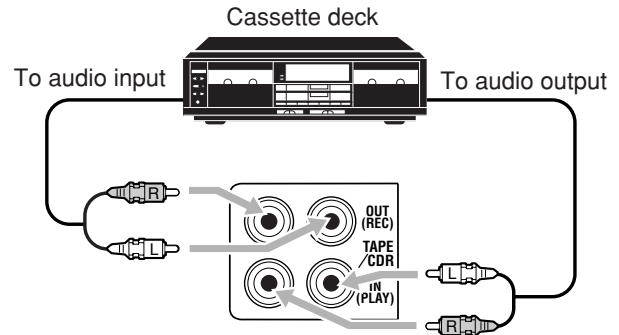
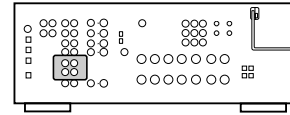

### CD recorder

To listen to the sound after connection, press TAPE/CDR.

You can connect either a CD recorder or a cassette deck to the TAPE/CDR jacks. When connecting a cassette deck to the TAPE/CDR jacks, see above.

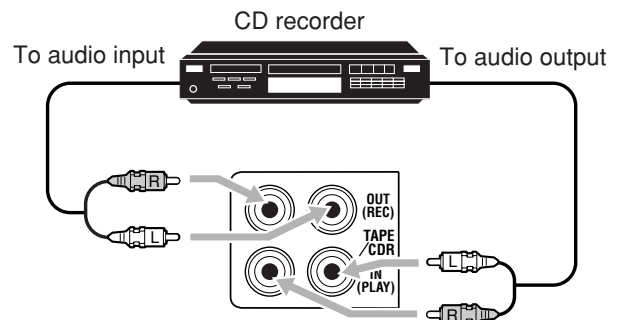
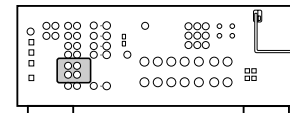

#### **Note:**

When connecting a CD recorder to the TAPE/CDR jacks, change the source name to "CDR," which will be shown on the display when it is selected as the source. See page 19 for details.

### Video component connections

Use the cables with RCA pin plugs (not supplied). Connect the white plug to the audio left jack, the red plug to the audio right jack, and the yellow plug to the video jack.

- If your video components have S-video (Y/C-separation) and/or component video (Y, Pb, Pr) terminals, connect them using an S-video cable (not supplied) and/or component video cable (not supplied). By using these jacks, you can get better picture quality in the order—Component video > S-video > Composite video.

#### If your video components have an AV COMPULINK jack

See also page 40 for detailed information about the connection and the AV COMPULINK remote control system.

#### IMPORTANT:

This receiver is equipped with the following video jacks—composite video, S-video and component video jacks. You can use any of the three to connect a video component.

However, **the video signals from one type of these input jacks are transmitted only through the video output jacks of the same type.**

Therefore, if a recording video component and a playing video component are connected to the receiver through the video jacks of different type, you cannot record the picture. In addition, if the TV and a playing video component are connected to the receiver through the video jacks of different type, you cannot view the playback picture on the TV.

#### VCR

To listen to the sound after connection, press VCR.

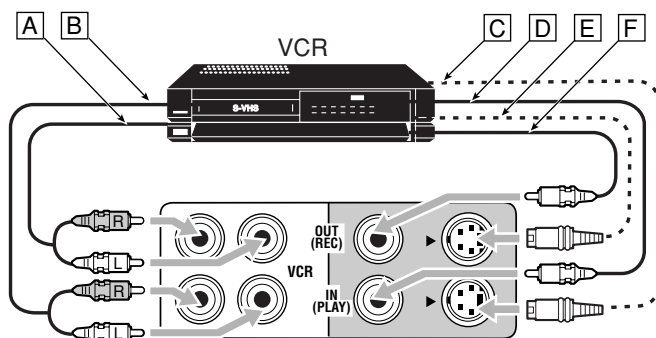
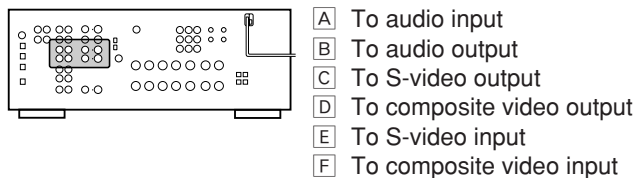

#### TV and/or DBS tuner

To listen to the sound after connection, press TV SOUND/DBS (or TV/DBS on the remote control).

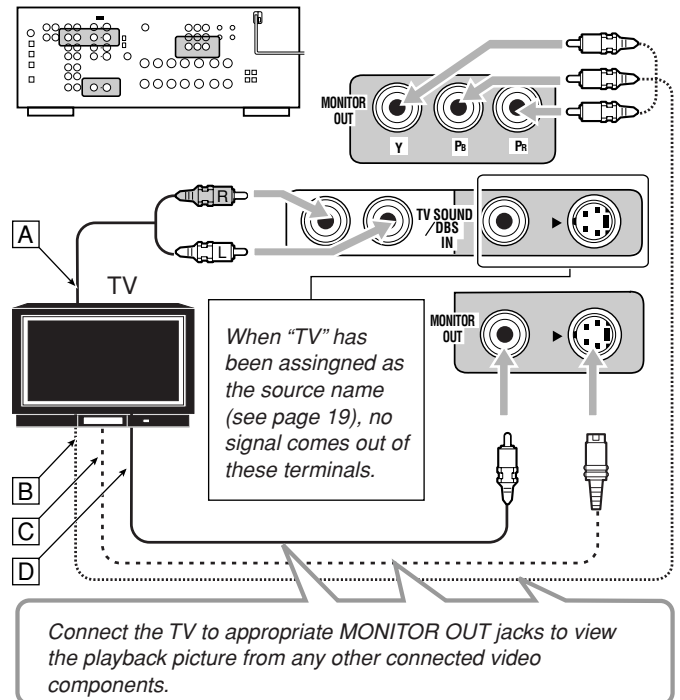

- A To audio output
- B To component video input
- C To S-video input
- D To composite video input

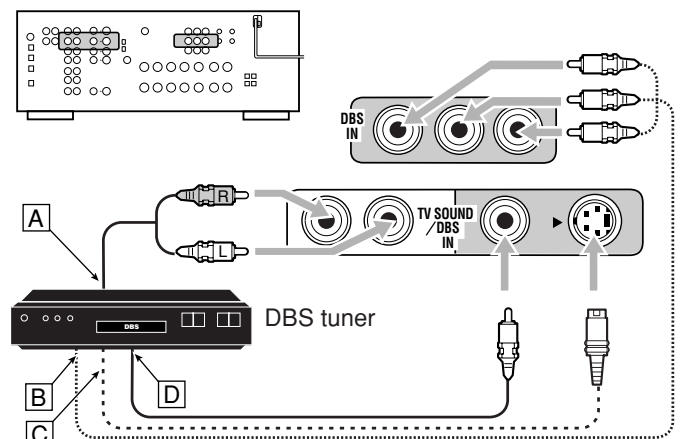

- A To audio output
- B To component video output
- C To S-video output
- D To composite video output

#### Notes:

- When connecting a DBS tuner to the TV SOUND/DBS IN jacks, change the source name to "DBS," which will be shown on the display when selected as the source. Otherwise you cannot view any picture from DBS tuner. See page 19 for details.
- When connecting a DBS tuner to the component input jacks (DBS IN), make the component video input setting correctly for AV COMPULINK. See page 28 for details.

## DVD player

- When you connect a DVD player with stereo output jacks:

To listen to the sound after connection, press DVD.

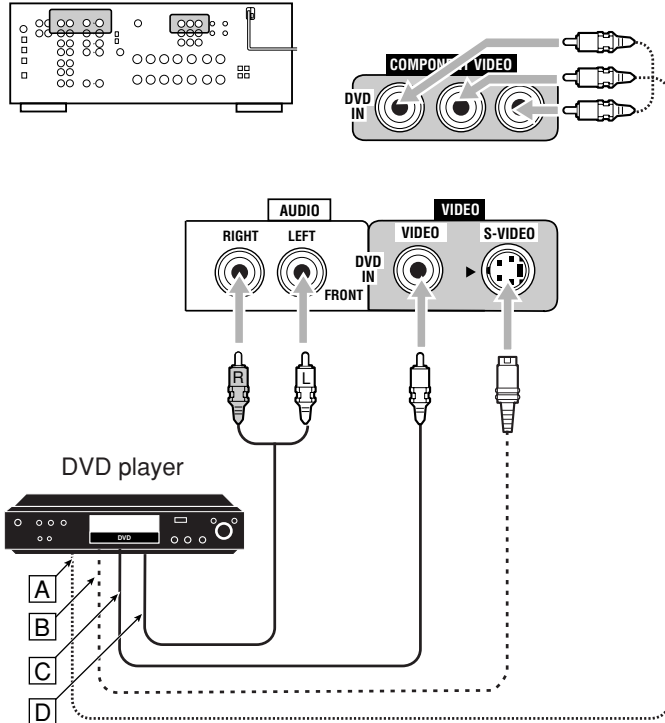

- A To component video output
- B To S-video output
- C To composite video output
- D To left/right front channel audio output (or to audio-mixed output if necessary)

### Note:

When connecting a DVD player to the component video input (DVD IN) jacks, make the component video input setting correctly for AV COMPU LINK. See page 28 for details.

- When you connect a DVD player with its analog discrete output (5.1-channel reproduction) jacks:

To listen to the sound after connection, press DVD MULTI.

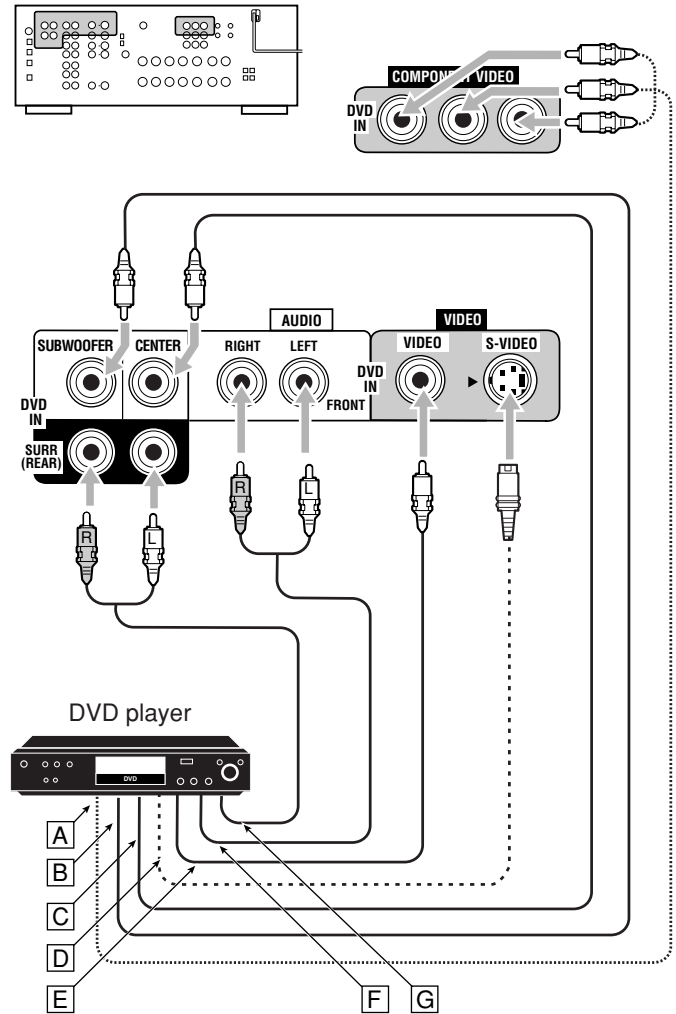

- A To component video output
- B To subwoofer output
- C To center channel audio output
- D To S-video output
- E To composite video output
- F To left/right front channel audio output
- G To left/right surround channel audio output

### Note:

When connecting a DVD player to the component video input (DVD IN) jacks, make the component video input setting correctly for AV COMPU LINK. See page 28 for details.

## Digital Connections

This receiver is equipped with four DIGITAL IN terminals—one digital coaxial terminal and three digital optical terminals—and one DIGITAL OUT (optical) terminal on the rear.

### IMPORTANT:

- When connecting a DVD player, digital TV broadcast tuner or DBS tuner using the digital terminals, you also need to connect it to the video jacks on the rear. Without connecting it to the video jacks, you can view no playback picture.
- After connecting the components using the DIGITAL IN terminals, set the following correctly if necessary.
  - Set the digital input (DIGITAL IN) terminal setting correctly. For details, see “Setting the Digital Input Terminals” on page 28.
  - Select the digital input mode correctly. For details, see “Selecting the Analog or Digital Input Mode” on page 17.

### Digital input terminals

You can connect any digital components having coaxial or optical digital output terminal.

Digital coaxial cable (not supplied)  
between digital coaxial terminals



Digital optical cable (not supplied)  
between digital optical terminals



When the component has a digital coaxial output terminal, connect it to the DIGITAL 1 (DVD) terminal, using a digital coaxial cable (not supplied).

When the component has a digital optical output terminal, connect it to the DIGITAL 2 (CD), DIGITAL 3 (TV) or DIGITAL 4 (CDR) terminal, using a digital optical cable (not supplied).

Before connecting a digital optical cable, unplug the protective plug.

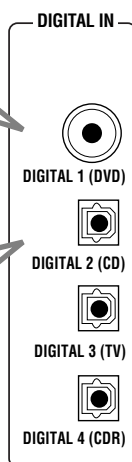
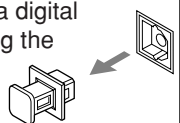

### Digital output terminal

You can connect any digital components which have an optical digital input terminal.

Digital optical cable (not supplied)  
between digital optical terminals

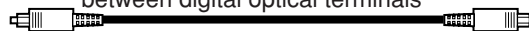

When the digital recording equipment such as an MD recorder and CD recorder has a digital optical input terminal, connecting it to the DIGITAL OUT terminal enables you to perform digital-to-digital recording.

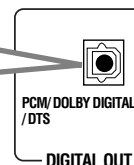

### Note:

The digital signal format transmitted through the DIGITAL OUT terminal is the same as that of the input signal. This means that when the DTS Digital Surround signals are input, the DTS Digital Surround signals are transmitted.

## Connecting the Power Cord

Before plugging the receiver into an AC outlet, make sure that all connections have been made.

**Plug the power cord into an AC outlet.**

Keep the power cord away from the connecting cables and the antenna. The power cord may cause noise or screen interference.

### Note:

The preset settings such as preset channels and sound adjustment may be erased in a few days in the following cases:

- When you unplug the power cord.
- When a power failure occurs.

### CAUTIONS:

- Do not touch the power cord with wet hands.
- Do not pull on the power cord to unplug the cord. When unplugging the cord, always grasp the plug so as not to damage the cord.

### Notes:

- When shipped from the factory, the DIGITAL IN terminals have been set for use with the following components:
  - DIGITAL 1 (coaxial): For DVD player
  - DIGITAL 2 (optical): For CD player
  - DIGITAL 3 (optical): For digital TV broadcast tuner
  - DIGITAL 4 (optical): For CD recorder
- When you want to operate the CD player or CD recorder, using the COMPU LINK remote control system, connect the target component also as described in “Analog Connections” (see page 11).
- When you want to operate a DVD player using the AV COMPU LINK remote control system (see page 40), connect the DVD player also as described in “Analog Connections” (see page 13).



# Basic Operations

The following operations are commonly used when you play any sound sources.

Operations hereafter will be explained using the buttons on the front panel.

You can also use the buttons on the remote control for the same functions if they have the same and similar names/marks.

## Daily Operational Procedure

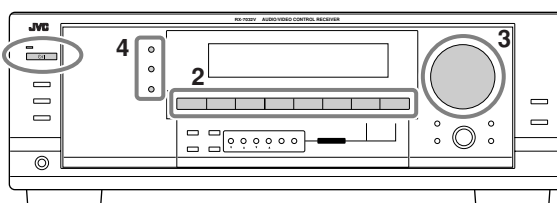

- 1 Turn on the power.**
  - See "Turning On the Power" below.
- 2 Select the source.**
  - See "Selecting the Source to Play" to the right.
- 3 Adjust the volume.**
  - See "Adjusting the Volume" on page 16.
- 4 Select the surround or DSP modes.**
  - See "Activating the Surround Modes" (page 35) and "Activating the DSP Modes" (page 37).

## Selecting the Source to Play

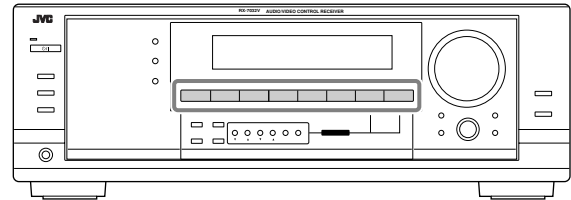

Press one of the source selection buttons.

The selected source name and the previously selected Surround/DSP mode appear on the display.

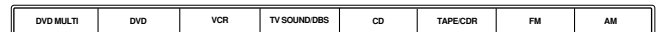
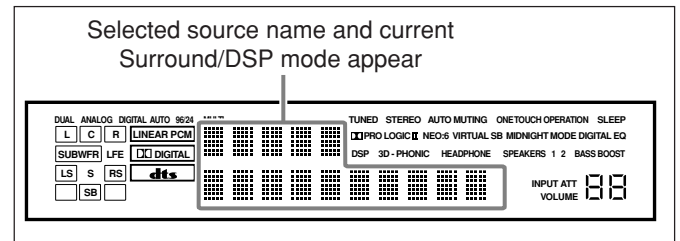

On the unit

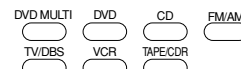

On the remote

## Turning On the Power

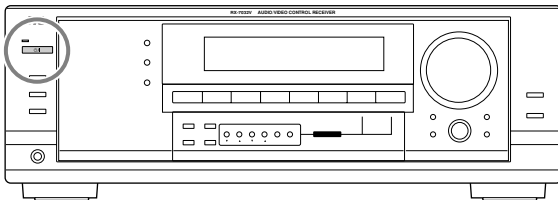

Press **STANDBY/ON** (or **AUDIO** on the remote control).

The STANDBY lamp goes off. The name of the current source and Surround/DSP mode appear on the display.

Current source name and Surround/DSP mode appear

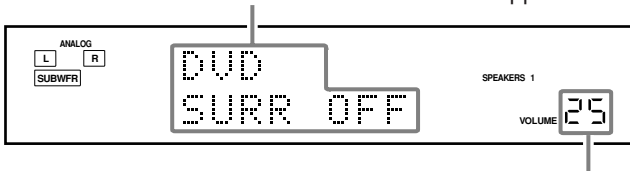

Current volume level appears

**To turn off the power (into standby mode),**

press **STANDBY/ON** (or **AUDIO** on the remote control) again.

The STANDBY lamp lights up.

### Note:

A small amount of power is consumed in standby mode. To turn off the power completely, unplug the AC power cord.

### Note:

When connecting CD recorder (to the TAPE/CDR IN jacks) and a DBS tuner (to the TV SOUND/DBS IN jacks), change the source names shown on the display. For details, see page 19.

## Speaker and signal indicators on the display

By checking the following indicators, you can easily confirm which speakers you are activating and which signals are coming into this receiver.

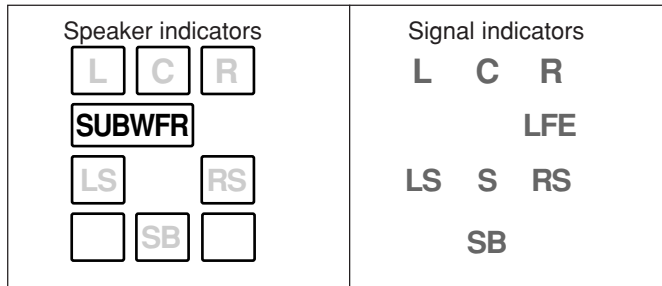

### What speaker indicators light depends on the speaker setting (for details, see "Setting the Speakers" on page 25).

- The frames of "L," "C," "R," "LS," "RS," and "SB" light up, when the corresponding speakers are set to "LARGE" or "SMALL" and when the speaker is required for the Surround/DSP mode currently selected.
- When "SUB WOOFER" is set to "YES," SUBWFR lights up (see page 25).
- All three frames on the row of "SB" are not used at the same time. When "SBACK OUT" is set to "2SPK," the left and the right ones are used. When it is set to "1SPK," the middle one is used (see page 26).

### The signal indicators light up to show the incoming signals.

- L: • **When digital input is selected:** Lights up when the left channel signal comes in.  
 • **When analog input is selected:** Always lights up.
- R: • **When digital input is selected:** Lights up when the right channel signal comes in.  
 • **When analog input is selected:** Always lights up.
- C: Lights up when the center channel signal comes in.
- LFE: Lights up when the LFE channel signal comes in.
- LS: Lights up when the left surround channel signal comes in.
- RS: Lights up when the right surround channel signal comes in.
- S: Lights up when the monaural surround channel signal comes in.
- SB: Lights up when the surround back channel signal comes in.

### Note:

When "DVD MULTI" is selected as the source, "L," "C," "R," "LFE," "LS," and "RS" light up.

### How to understand the speaker and signal indicator illumination

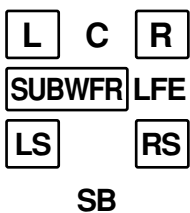

Ex. No sound comes out of the center speaker and surround back speakers though center channel and surround back channel signals are coming into this receiver.

## Selecting different sources for picture and sound

While watching pictures from a video source, you can listen to sound of an audio source.

- Once you have selected a video source, pictures of the selected source are sent to the TV until you select another video source.

Press one of the audio source selection buttons while viewing the picture from a video component such as the VCR or DVD player, etc.

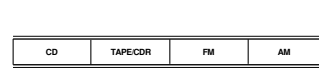

On the unit

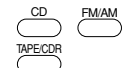

On the remote

### Note:

When you watch the picture through the COMPONENT VIDEO jacks, you cannot use this function.

## Adjusting the Volume

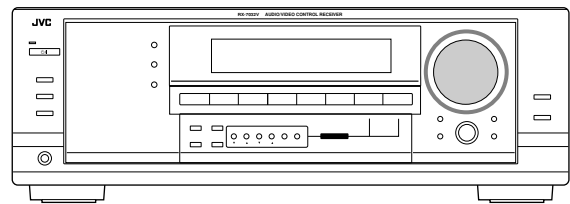

### On the front panel:

To increase the volume, turn MASTER VOLUME clockwise.  
 To decrease the volume, turn it counterclockwise.

### From the remote control:

To increase the volume, press VOLUME +.  
 To decrease the volume, press VOLUME -.

### CAUTION:

Always set the volume to the minimum before starting any sources. If the volume is set at its high level, the sudden blast of sound energy can permanently damage your hearing and/or ruin your speakers.

### Notes:

- The volume level can be adjusted within the range of "0" (minimum) to "70" (maximum).
- If you set One Touch Operation to "ON" (see page 28), you do not have to adjust the volume level each time you change the source. It is automatically set to the stored level.

## Selecting the Front Speakers



When you have connected two pairs of the front speakers, you can select which to use.

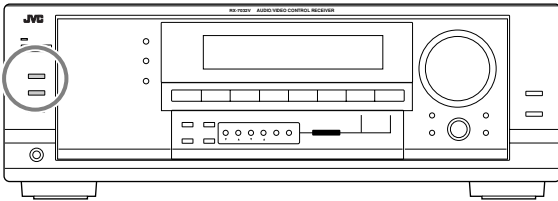

To use the speakers connected to the **FRONT SPEAKERS ① terminals**, press **SPEAKERS ON/OFF 1** so that the **SPEAKERS 1** indicator lights up on the display. Make sure that the **SPEAKERS 2** indicator is not lit on the display.

To use the speakers connected to the **FRONT SPEAKERS ② terminals**, press **SPEAKERS ON/OFF 2** so that **SPEAKERS 2** indicator lights up on the display. Make sure that the **SPEAKERS 1** indicator is not lit on the display.

To use **both sets of the speakers**, press **SPEAKERS ON/OFF 1** and **SPEAKERS ON/OFF 2** so that the **SPEAKERS 1/2** indicators light up on the display.

To use **neither sets of the speakers**, press **SPEAKERS ON/OFF 1** and **SPEAKERS ON/OFF 2** so that the **SPEAKERS 1/2** indicators go off from the display.

The **HEADPHONE** indicator lights up and “**HEADPHONE**” appears on the display.

- Activating the speakers turns on the Surround and DSP modes previously selected.

### Listening with headphones only:

Deactivate both sets of the front speakers, and connect headphones to the **PHONES** jack.

You can enjoy the sound effects through the headphones when Surround or DSP mode is activated—**3D HEADPHONE (3D H PHONE)** mode.

- “**3D H PHONE**” appears on the display and the **DSP** and **HEADPHONE** indicator lights up on the display. (For details, see page 36.)

### Note:

When you select “**DVD MULTI**” as the source or any one of the Surround/DSP mode which activates the center and/or surround speaker(s), you can use only one set of the speakers.

### CAUTION:

Be sure to turn down the volume:

- Before connecting or putting on headphones, as its high volume can damage both the headphones and your hearing.
- Before turning on speakers again, as its high volume may come out of the speakers.

## Activating and Adjusting the Subwoofer Sound



You can cancel the subwoofer sound even though you have connected a subwoofer and have set “**SUB WOOFER**” to “**YES**” (see page 25). This is useful when enjoying surround sound at night.

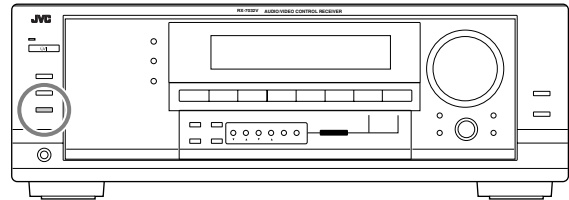

Press **SUBWOOFER OUT ON/OFF** to cancel the subwoofer sound output.

Each time you press the button, subwoofer sound output is deactivated (“**SUBWFR OFF**”) and activated (“**SUBWFR ON**”) alternately.

- When subwoofer sound output is activated, subwoofer output level can be adjusted using the remote control.
  - Press **SOUND**.
  - Press **SUBWOOFER**.
  - Press **LEVEL +** or **-** to adjust the output level (–10 dB to +10 dB).

### Note:

You cannot deactivate the subwoofer sound output when you set “**SMALL**” for the front speakers on the speaker size setting (see page 25) or **Quick Speaker Setup** (see page 23).

## Selecting the Analog or Digital Input Mode

When you have connected digital source components using the digital terminals (see page 14), change the input mode for these components to the digital input mode.

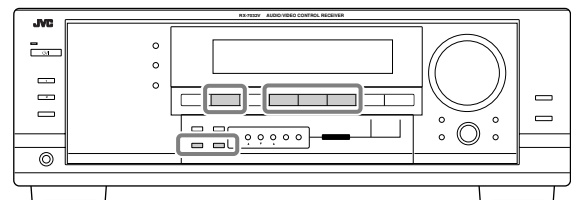

Before you start, remember...

The digital input terminal setting should be correctly done for the sources you want to select the digital input mode (see “**Setting the Digital Input Terminals**” on page 28).

- Press one of the source selection buttons for which you want to change the input mode.

DVD, TV (SOUND)/DBS, CD, or TAPE/CDR\*

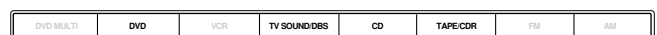

On the unit

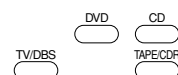

On the remote

- \* If “**TAPE**” has been assigned as the source name, digital input mode is not available. To change the source name, see “**Changing the Source Name**” on page 19.

**2. Press INPUT DIGITAL (or ANALOG/DIGITAL INPUT on the remote control) to select “DGTL AUTO.”**

The DIGITAL AUTO indicator lights up on the display.

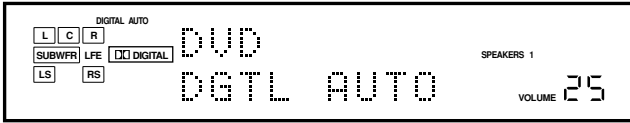

- When selecting “DGTL AUTO,” the following indicators indicate the digital signal format of the incoming signal.

**LINEAR PCM** : Lights up when Linear PCM signals come in.

**DIGITAL** : Lights up when Dolby Digital signals come in.

**dts** : Lights up when DTS signals come in.

No indicator lights up when the receiver cannot recognize the digital signal format of the incoming signals.

**When playing software encoded with the Dolby Digital or DTS, the following symptoms may occur:**

- Sound does not come out at the beginning of playback.
- Noise comes out while searching for or skipping chapters or tracks.

In this case, press INPUT DIGITAL repeatedly to select “DGTL D.D” or “DGTL DTS.”



- As you press INPUT DIGITAL, the input mode changes as follows:

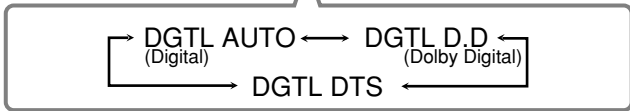

When “DGTL D.D” or “DGTL DTS” is selected, the AUTO indicator goes off, and the corresponding digital signal format indicator lights up on the display.

- If the incoming signal does not match the selected digital signal format, the frame of the selected indicator will flash.

**Note:**

When you turn off the power or select another source, “DGTL D.D” and “DGTL DTS” settings are canceled and the digital input mode is automatically reset to “DGTL AUTO.”

**To select the analog input mode again**

Press INPUT ANALOG (or press ANALOG/DIGITAL INPUT on the remote control repeatedly until “ANALOG” appears on the display). The ANALOG indicator lights up.



**Setting the Dynamic Range**

You can enjoy a powerful sound at night using the Midnight Mode.

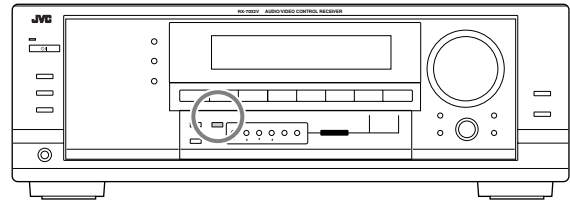

Press MIDNIGHT MODE so that “MID NIGHT 1” or “MID NIGHT 2” appears on the display.

The MIDNIGHT MODE indicator also lights up.

**MID NIGHT 1:** Select when you want to reduce the dynamic range a little.

**MID NIGHT 2:** Select when you want to apply the compress effect fully (useful at midnight).

**MID NIGHT OFF:** Select when you want to enjoy surround with its full dynamic range (no effect applied).

**Notes:**

- If Analog Direct is in use, Midnight Mode is temporarily canceled.
- Midnight Mode is not valid for DVD MULTI playback mode.

**Attenuating the Input Signal**



When the input level of the analog source is too high, the sounds will be distorted. If this happens, you need to attenuate the input signal level to prevent the sound distortion.

- Once you have made adjustment, it is memorized for each analog source.

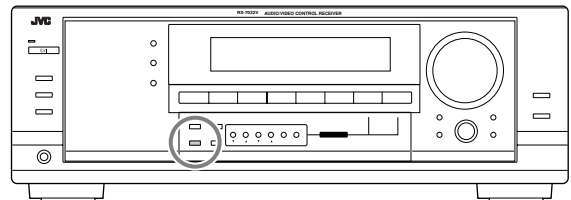

Press and hold INPUT ATT (INPUT ANALOG) so that the INPUT ATT indicator lights up on the display.

- Each time you press and hold the button, the input attenuator mode turns on (“ATT ON”) or off (“NORMAL”).

**Note:**

This function is not valid when “DVD MULTI” is selected or when Analog Direct is activated.

## Turning Analog Direct On and Off

You can enjoy the sound closer to the original source by overriding the sound adjustments such as speaker output level adjustments (see page 30), Digital Equalization (see page 30), Surround and DSP modes (see pages 32 to 37), Bass Boost (see page 20) and Midnight Mode (see page 18). You can only adjust the volume level while Analog Direct is in use.

- Once you have made adjustment, it is memorized for each analog source.

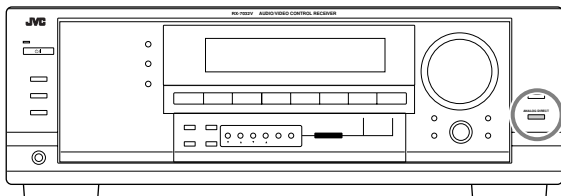

Press ANALOG DIRECT so that "A DIRECT" appears on the display.



The lamp on the button also lights up.

- Each time you press the button, Analog Direct turns on and off.

### Notes:

- When digital input mode is in use, Analog Direct is not available.
- Turning on Surround or DSP mode cancels Analog Direct and previously selected sound adjustments are recalled.
- If Analog Direct is in use, Midnight Mode is temporarily canceled.
- Turning on Analog Direct cancels Input Attenuator (see page 18).

## Changing the Source Name



When you have connected an CD recorder to the TAPE/CDR IN jacks or a DBS tuner to the TV SOUND/DBS IN jacks on the rear panel, change the source name which will be shown on the display.

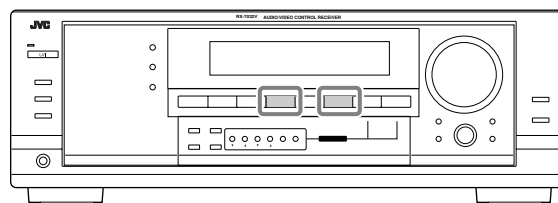

When changing the source name from "TV" to "DBS":

1. Press TV SOUND/DBS.
  - Make sure "TV" appears on the display.
2. Press and hold TV SOUND/DBS until "ASSGN DBS" appears on the display.

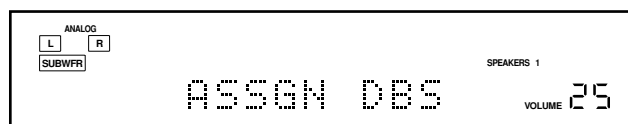

### Note:

When connecting a DBS tuner to the TV SOUND/DBS IN jacks, change the source name to "DBS," which will be shown on the display when selected as the source. Otherwise you cannot view any picture from the DBS tuner.

When changing the source name from "TAPE" to "CDR":

1. Press TAPE/CDR.
  - Make sure "TAPE" appears on the display.
2. Press and hold TAPE/CDR until "ASSGN CDR" appears on the display.



To change the source name to "TV" and "TAPE," repeat the same procedure above.

### Note:

Without changing the source name, you can still use the connected components. However, there may be some inconvenience.

- "TAPE" or "TV" will appear on the display when you select the CD recorder or DBS tuner.
- You cannot use the digital input (see page 17) for the CD recorder.

The following basic operations are possible only using the remote control.

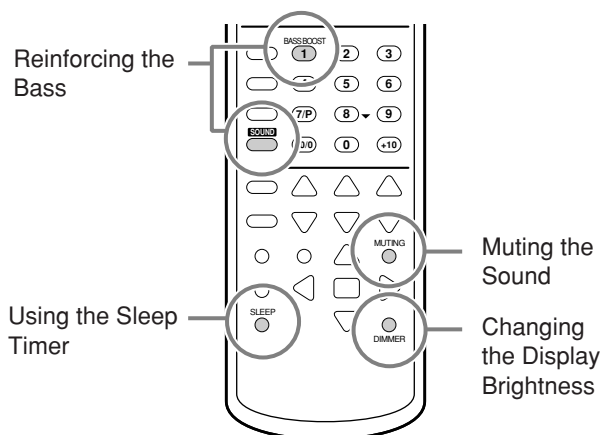

## Reinforcing the Bass

You can boost the bass level.

- Once you have made adjustment, it is memorized for each source.

### 1. Press SOUND.

The 10 keys are activated for sound adjustments.

### 2. Press BASS BOOST to turn on Bass Boost.

The BASS BOOST indicator lights up.

- Each time you press the button, Bass Boost turns on (“BOOST ON”) and off (“BOOST OFF”) alternately.

You can use the BASS BOOST button on the front panel.

When the Bass Boost is activated, the lamp on the button lights up.

- Each time you press the button, Bass Boost turns on and off.

### Notes:

- This function affects only the sounds from the front speakers, center speaker, and subwoofer.
- When Analog Direct is activated (see page 19), the Bass Boost is canceled temporarily.

## Muting the Sound

Press MUTING to mute the sound through all speakers and headphones connected.

“MUTING” appears on the display and the volume turns off (the VOLUME level indicator goes off).

To restore the sound, press MUTING again.

- Turning MASTER VOLUME on the front panel or pressing VOLUME +/- on the remote control also restores the sound.

## Changing the Display Brightness

You can dim the display.

Press DIMMER.

- Each time you press the button, the brightness level of the display change as follows:

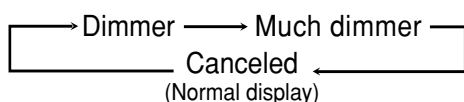

## Using the Sleep Timer

Using the Sleep Timer, you can fall asleep while listening to music. When the shut-off time comes, the receiver turns off automatically.

### Press SLEEP repeatedly.

The SLEEP indicator lights up on the display, and the shut-off time changes in 10 minutes intervals:

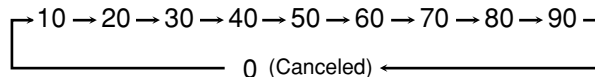

### To check or change the time remaining until the shut-off time:

Press SLEEP once.

The remaining time until the shut-off time appears in minutes.

- To change the shut-off time, press SLEEP repeatedly.

### To cancel the Sleep Timer:

Press SLEEP repeatedly until “SLEEP 0min” appears on the display. (The SLEEP indicator goes off.)

- Turning off the power also cancels the Sleep Timer.

## Recording a source

### For analog-to-analog recording

You can record any analog playback source onto the recording components connected to the audio output jacks on the rear of this unit at the same time.

### For digital-to-digital recording

You can record the currently selected digital input source through the receiver to a digital recording device connected to the DIGITAL OUT terminal.

### Notes:

- Analog-to-digital and digital-to-analog recordings are not possible.
- The output volume level, Midnight Mode (see page 18), Bass Boost (see the left column), Digital Equalization (see page 30), Surround modes and DSP modes (see pages 32 to 37) cannot affect the recording.

## Basic adjustment auto memory

This receiver memorizes sound settings for each source—

- when you turn off the power,
- when you change the source, and
- when you assign the source name (see page 19).

When you change the source, the memorized settings for the newly selected source are automatically recalled.

The following can be stored for each source:

- Analog/digital input mode (see pages 17 and 18)
- Input attenuator mode (see page 18)
- Analog Direct (see page 19)
- Digital Equalization (see page 30)
- Speaker channel output levels (see page 30)
- Surround and DSP mode selection (see pages 35 and 37)
- Bass Boost setting (see the left column)

### Notes:

- If the source is FM or AM, you can assign a different setting for each band.
- If you want to memorize the volume level with the above settings, set One Touch Operation to “ON” (see page 28).

# Receiving Radio Broadcasts

You can browse through all the stations or use the preset function to go immediately to a particular station.

## Tuning in to Stations Manually

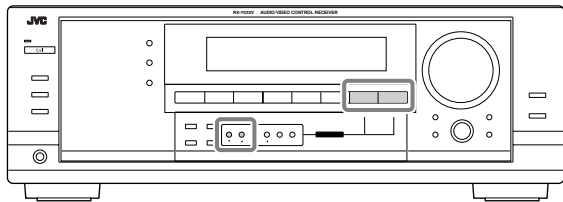

### 1. Press FM or AM to select the band.

The last received station of the selected band is tuned in.

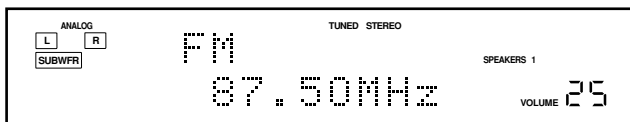

### 2. Press FM/AM TUNING ▲ or ▼ repeatedly until you find the frequency you want.

- Pressing FM/AM TUNING ▲ increases the frequency.
- Pressing FM/AM TUNING ▼ decreases the frequency.

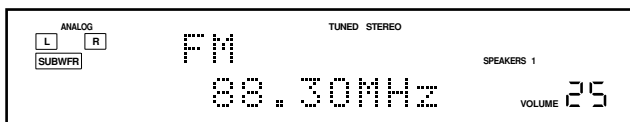

#### Notes:

- When a station of sufficient signal strength is tuned in, the TUNED indicator lights up on the display.
- When an FM stereo program is received, the STEREO indicator also lights up.
- When you hold and then release the button in step 2, the frequency keeps changing until a station is tuned in.

#### From the remote control:

1. Press FM/AM.
  - Each time you press the button, the band alternates between FM and AM.
2. Press TUNING UP or TUNING DOWN repeatedly until you find the frequency you want.
  - Pressing TUNING UP increases the frequency.
  - Pressing TUNING DOWN decreases the frequency.

## Using Preset Tuning

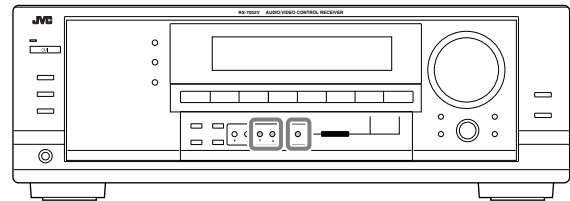

Once a station is assigned to a channel number, the station can be quickly tuned in. You can preset up to 30 FM and 15 AM stations.

### To store the preset stations

#### Before you start, remember...

There is a time limit in doing the following steps. If the setting is canceled before you finish, start from step 2 again.

#### On the front panel ONLY:

### 1. Tune in the station you want to preset (see "Tuning in to Stations Manually" on the left).

- If you want to store the FM reception mode for this station, select the FM reception mode you want. See "Selecting the FM Reception Mode" on page 22.

### 2. Press MEMORY.

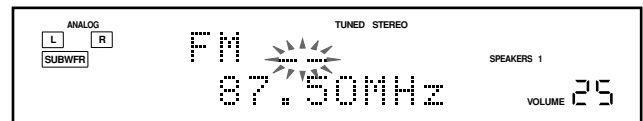

The channel number position starts flashing on the display for about 10 seconds.

### 3. Press FM/AM PRESET ▲ or ▼ to select a channel number while the channel number position is flashing.

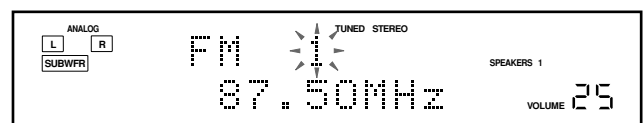

### 4. Press MEMORY again while the selected channel number is flashing.

The selected channel number stops flashing.

The station is assigned to the selected channel number.

### 5. Repeat steps 1 to 4 until you store all the stations you want.

#### To erase a stored preset station

Storing a new station on a used number erases the previously stored one.

## To tune in a preset station

*On the front panel:*

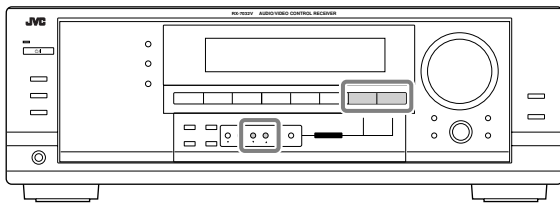

1. **Press FM or AM to select the band.**  
The last received station of the selected band is tuned in.
2. **Press FM/AM PRESET ▲ or ▼ until you find the channel you want.**
  - Pressing FM/AM PRESET ▲ increases the number.
  - Pressing FM/AM PRESET ▼ decreases the number.

*From the remote control:*

1. **Press FM/AM to select the band.**  
The last received station of the selected band is tuned in.
  - Each time you press the button, the band alternates between FM and AM.
2. **Press the 10 keys to select a preset channel number.**
  - For channel number 5, press 5.
  - For channel number 15, press +10 then 5.
  - For channel number 20, press +10 then 10/0.
  - For channel number 30, press +10, +10, then 10/0.

### **Note:**

When you use the 10 keys on the remote control, be sure that they are activated for the tuner, not for the CD and others. (See page 42.)

## Selecting the FM Reception Mode

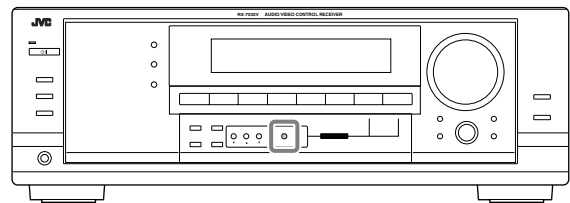

When an FM stereo broadcast is hard to receive or noisy, you can change the FM reception mode while receiving an FM broadcast.

- You can store the FM reception mode for each preset station (see page 21).

### **While listening to an FM station, press FM MODE.**

- Each time you press the button, the FM reception mode alternates between "AUTOMUTING" and "MODE MONO."

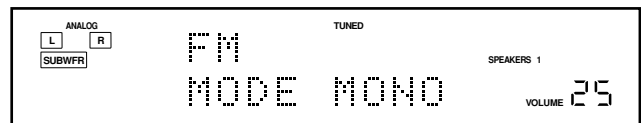
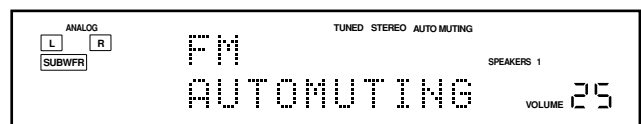

- 
- AUTOMUTING:** Normally select this.  
When a program is broadcasted in stereo, you will hear stereo sound; when in monaural, you will hear monaural sounds.  
This mode is also useful to suppress static noise between stations. The AUTO MUTING indicator lights up on the display. (Initial setting)
- 
- MODE MONO:** Select this to improve the reception (but stereo effect will be lost).  
In this mode, you will hear noise while tuning into the stations. The AUTO MUTING indicator goes off from the display. (The STEREO indicator also goes off.)
- 

### **Note:**

When you use the FM MODE on the remote control, be sure that it is activated for the tuner, not for the CD and others. (See page 42.)



# Basic Settings

Some of the following settings are required after connecting and positioning your speakers while others will make operations easier. You can use QUICK SPEAKER SETUP to easily set up your speaker configuration.

## Setting the Speakers Configuration



Quick Speaker Setup helps you to easily and quickly register the speaker size and speaker distance according to your listening room to create the best possible surround effect.

- You can also register each speaker's information manually. For details, see page 25.

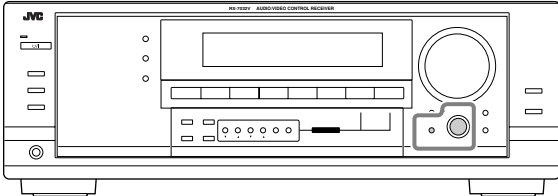

### Before you start, remember...

There is a time limit in doing the following steps. If the setting is canceled before you finish, start from step 1 again.

### On the front panel:

#### 1. Press QUICK SPEAKER SETUP.

"SETUP" and "SPEAKERS?" appear on the display, then the initial setting for the total number of the connected speakers (channels) appears.



#### 2. Turn MULTI JOG to select an appropriate number of the connected speakers (speaker channel number).

The speaker channel number changes as follows.

- For the details of speaker channel number, see "Speakers (channels) number and size" on page 24.

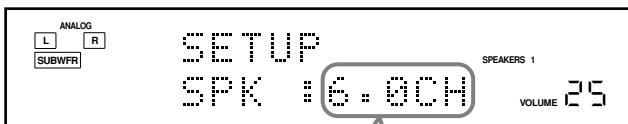

2.0CH ⇄ 2.1CH ⇄ 3.0CH ⇄ 3.1CH ⇄ 4.0CH ⇄  
4.1CH ⇄ 5.0CH ⇄ 5.1CH ⇄ **6.0CH\*** ⇄ 6.1CH ⇄  
7.0CH ⇄ 7.1CH ⇄ (Back to the beginning)

\* "6.0CH" is the initial setting.

#### 3. Press in MULTI JOG (PUSH SET).

"ROOM SIZE?" appears on the display, then the initial room size setting appears.

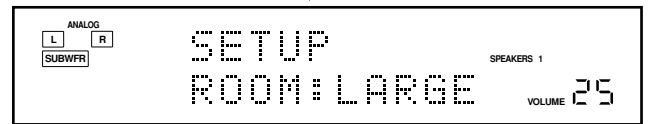
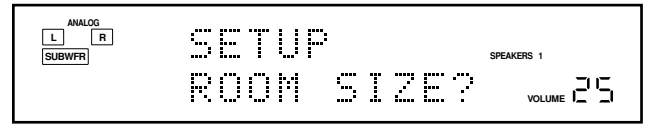

#### 4. Turn MULTI JOG to select an appropriate room size to match to your listening room.

The room size changes as follows.

- To select your appropriate room size, see "Room size and speaker distance" on page 24.



SMALL ⇄ MID ⇄ **LARGE\*** ⇄ (Back to the beginning)

\* "LARGE" is the initial setting.

#### 5. Press in MULTI JOG (PUSH SET).

"COMPLETE" appears on the display, then goes back to the source indication.

- Speaker configuration settings now become active.



### Note:

This procedure will not be completed if you stop in the middle of the setting process.

### Speakers (channels) number and size

You can find how each of the speaker size is defined according to the number of connected speakers (speaker channel (CH) number) you select.

In the following tables, "L" stands for "left front speaker," "R" for "right front speaker," "C" for "center speaker," "LS" for "left surround speaker," "RS" for "right surround speaker," "SB" for "surround back speaker," and "SUBWFR" for "subwoofer."

- Subwoofer is counted as 0.1 channel.

CH	The size of connected speakers						
	L	R	C	LS	RS	SB	SUBWFR
2.0	LARGE	LARGE	NONE	NONE	NONE	NONE	NO
2.1	SMALL	SMALL	NONE	NONE	NONE	NONE	YES
3.0	LARGE	LARGE	SMALL	NONE	NONE	NONE	NO
3.1	SMALL	SMALL	SMALL	NONE	NONE	NONE	YES
4.0	LARGE	LARGE	NONE	SMALL	SMALL	NONE	NO
4.1	SMALL	SMALL	NONE	SMALL	SMALL	NONE	YES
5.0	LARGE	LARGE	SMALL	SMALL	SMALL	NONE	NO
5.1	SMALL	SMALL	SMALL	SMALL	SMALL	NONE	YES
6.0	LARGE	LARGE	SMALL	SMALL	SMALL	SMALL	NO
6.1	SMALL	SMALL	SMALL	SMALL	SMALL	SMALL	YES
7.0	LARGE	LARGE	SMALL	SMALL	SMALL	SMALL*	NO
7.1	SMALL	SMALL	SMALL	SMALL	SMALL	SMALL*	YES

\* This setting is applied to the both speakers.

### Room size and speaker distance

According to the selected room size, speaker distance for each activated speaker is set as follows:

LARGE	Speaker	Distance
	L	3.0 m (10 ft)
	R	3.0 m (10 ft)
	C	3.0 m (10 ft)
	LS	3.0 m (10 ft)
	RS	3.0 m (10 ft)
	SB	3.0 m (10 ft)
MID	Speaker	Distance
	L	2.7 m (9 ft)
	R	2.7 m (9 ft)
	C	2.4 m (8 ft)
	LS	2.1 m (7 ft)
	RS	2.1 m (7 ft)
	SB	1.8 m (6 ft)
SMALL	Speaker	Distance
	L	2.4 m (8 ft)
	R	2.4 m (8 ft)
	C	2.1 m (7 ft)
	LS	1.5 m (5 ft)
	RS	1.5 m (5 ft)
	SB	1.2 m (4 ft)

## Basic Setting Items

On the following pages, you can adjust the following items:

Items	To do	See page
<b>SUB WOOFER*</b>	Register your subwoofer.	25
<b>FRONT SPEAKER*</b>	Register your front speaker size.	25
<b>CNTR SPEAKER*</b>	Register your center speaker size.	25
<b>SURR SPEAKER*</b>	Register your surround speaker size.	25
<b>SBACK SPEAKER*</b>	Register your surround back speaker size.	25
<b>SBACK OUT*</b>	Register the number of the connected surround back speakers.	26
<b>DIST UNIT</b>	Select the measuring unit for the speaker distance.	26
<b>FRONT DISTANCE*</b>	Register the distance from you front speakers to your listening point.	26
<b>CNTR DISTANCE*</b>	Register the distance from you center speaker to your listening point.	26
<b>SURR DISTANCE*</b>	Register the distance from you surround speakers to your listening point.	26
<b>SBACK DISTANCE*</b>	Register the distance from you surround back speaker(s) to your listening point.	26
<b>S WFR OUTPUT</b>	Select sounds emitted from the subwoofer.	27
<b>CROSS OVER</b>	Select the cutoff frequency to the subwoofer.	27
<b>LFE ATTENUATE</b>	Attenuate the bass (LFE) sounds.	27
<b>DUAL MONO</b>	Select the Dual Mono sound channel.	27
<b>DGTL IN COAX</b>	Select the component connected to digital coaxial terminal	28
<b>DGTL IN OPTICAL</b>	This item is automatically set according to your "DGTL IN COAX" setting.	28
<b>VIDEO IN DVD</b>	Select the type of video terminal used for the DVD player.	28
<b>VIDEO IN DBS</b>	Select the type of video terminal used for the DBS tuner.	28
<b>ONE TOUCH OPE</b>	Store the volume level for each source.	28

\* These items can be set using Quick Speaker Setup.

## Basic Procedure

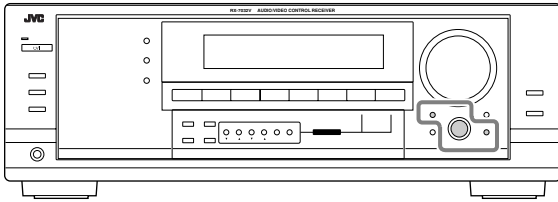

### Before you start, remember...

There is a time limit in doing the following steps. If the setting is canceled before you finish, start from step 1 again.

Ex. When setting One Touch Operation to "ON:"

#### 1. Press SETTING.

The last selected item appears on the display.

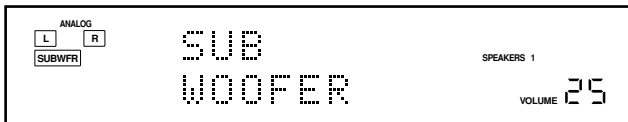

#### 2. Turn MULTI JOG until an item you want appears on the display.

- In this example, select "ONE TOUCH OPE." For available items, see the list "Basic Setting Items" on page 24.

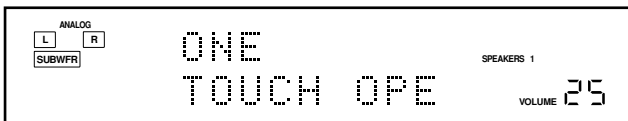

#### 3. Push in MULTI JOG (PUSH SET).

The current setting for the selected item appears on the display.

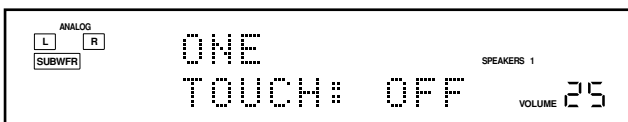

#### 4. Turn MULTI JOG until a setting you want appears on the display.



#### 5. Press EXIT.

#### 6. Repeat steps 2 to 5 to set other items if necessary.

#### 7. Press EXIT.

The source indication resumes on the display.

 : shows the initial setting in the following tables.

## Setting the Speakers

To obtain the best possible surround effect from the Surround and DSP modes, register the setting about the speaker arrangement after all connections are completed.

- If you have used Quick Speaker Setup on page 23, this setting is not required.

### ■ Subwoofer setting—SUB WOOFER

Select whether you have connected a subwoofer or not.

**YES:** Select when a subwoofer is connected.

**NO:** Select when no subwoofer is used.

#### Note:

If you have selected "NO" for the subwoofer, you cannot use the SUBWOOFER OUT ON/OFF button on the front panel.

### ■ Speaker size—FRONT SPEAKER, CNTR SPEAKER, SURR SPEAKER, SBACK SPEAKER

Select the size for each connected speaker.

**LARGE\*1:** Select when the speaker size is relatively large.

**SMALL\*2:** Select when the speaker size is relatively small.

**NONE:** Select this when you have not connected a speaker. (Not selectable for the front speakers)

\*1 Initial setting for front speakers.

\*2 Initial setting for center, surround, and surround back speakers.

#### Notes:

- Keep the following comments in mind as reference when adjusting.
  - If the size of the cone speaker unit built in your speaker is larger than 12 cm, select "LARGE," and if it is smaller than 12 cm, select "SMALL."
- If you have selected "NO" for the subwoofer setting, you can only select "LARGE" for the front speakers.
- If you have selected "SMALL" for the front speakers, you cannot select "LARGE" for the center, surround, and surround back speakers.
- If you have selected "SMALL" for the surround speakers, you cannot select "LARGE" for the surround back speakers.
- If you have selected "NONE" for the surround speakers, the surround back speakers are fixed to "NONE."

■ **Surround back speakers quantity—SBACK OUT**

Select the number of the surround back speakers connected.

**1SPK:** Select this to use 1 surround back speaker.

**2SPK:** Select this to use 2 surround back speakers.

**Note:**

If you have selected "NONE" for the surround back speakers (see page 25), this setting is not available.

**Setting the Speaker Distance**

The distance from your listening point to the speakers is another important element to obtain the best possible sound of the Surround and DSP modes. Set the distance from your listening point to the speakers.

By referring to the speaker distance setting, this unit automatically sets the delay time of the sound through each speaker so that sounds through all the speakers can reach you at the same time.

- If you have used Quick Speaker Setup on page 23, this setting is not required.

■ **Measuring unit—DIST UNIT**

Select which measuring unit you use.

**meter:** Select to set the distance in meters.

**feet:** Select to set the distance in feet.

■ **Speaker distance—FRONT DISTANCE, CNTR DISTANCE, SURR DISTANCE, SBACK DISTANCE**

Set the distance from the listening point within the range of 0.3 m (1 ft) to 9.0 m (30 ft), in 0.3 m (1 ft) intervals.

- When shipped from the factory, distance for each speaker is set to "3.0 m (10 ft)."

**Notes:**

- You cannot set the speaker distance for the speakers you have selected "NONE" (see page 25).
- This setting is not valid for the DVD MULTI playback mode.

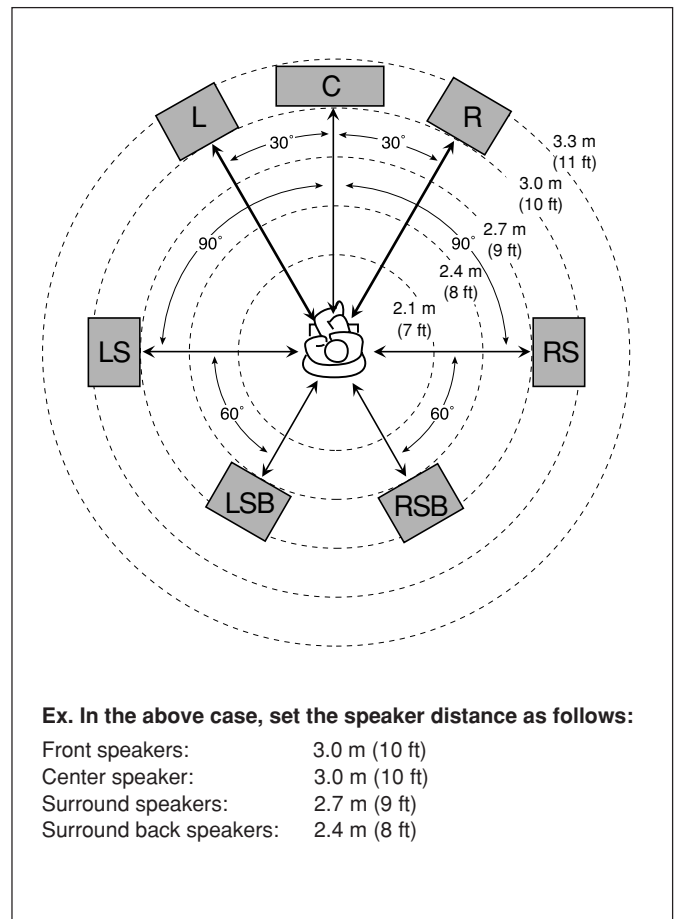

## Setting the Bass Sounds

You can adjust subwoofer and bass sounds precisely according to your preference.

### ■ **Subwoofer output—S WFR OUTPUT**

You can select the type of the signal which can be transmitted through the subwoofer. In other words, you can determine whether or not the bass elements of the front speaker channels are transmitted through the subwoofer regardless of the front speaker size setting (either "SMALL" or "LARGE").

Select one of the following:

<b>LFE:</b>	Select to transmit only the LFE signals (while playing Dolby Digital and DTS software) and the bass elements of small speakers through the subwoofer.
<b>LFE+MAIN:</b>	Select to always add the bass elements of the front speaker channels (MAIN) to the above (LFE) setting, and to transmit them through the subwoofer.

#### **Note:**

If you have selected "NO" for the subwoofer, this function is not available.

### ■ **Crossover frequency—CROSS OVER**

When you use a subwoofer, you can select the cutoff frequency for the small speakers used.

Select one of the crossover frequency levels according to the size of the small speaker connected.

<b>80Hz:</b>	Select when the cone speaker unit built in the speaker is about 12 cm.
<b>100Hz:</b>	Select when the cone speaker unit built in the speaker is about 10 cm.
<b>120Hz:</b>	Select when the cone speaker unit built in the speaker is about 8 cm.
<b>150Hz:</b>	Select when the cone speaker unit built in the speaker is about 6 cm.

#### **Notes:**

- If you have selected "LARGE" for all activated speakers (see page 25), this function is fixed to "OFF."
- Crossover frequency is not valid for the DVD MULTI playback, All Channel Stereo, HEADPHONE, and 3D HEADPHONE mode.

### ■ **Low frequency effect attenuator—LFE ATTENUATE**

If the bass sound is distorted while playing back software encoded with Dolby Digital or DTS, set the LFE level to eliminate distortion.

Select one of the following:

<b>0dB:</b>	Normally select this.
<b>-10dB:</b>	Select when the bass sound is distorted.

## Selecting main or sub channel—DUAL MONO

When the playback source is Dual Mono, you can select which, or both channels to listen to.

Select the playback sounds (channel).

<b>MAIN:</b>	Select to play back the main channel (Ch1). <sup>*1</sup> Signal indicator "L" lights up while playing back this channel.
<b>SUB:</b>	Select to play back the sub-channel (Ch2). <sup>*1</sup> Signal indicator "R" lights up while playing back this channel.
<b>ALL:</b>	Select to play back both the main and sub-channels (Ch1/Ch2). <sup>*1</sup> Signal indicators "L" and "R" light up while playing back these channels.

#### **Notes:**

- The Dual Mono format is not identical with bilingual broadcasting for TV programs. So this setting does not take effect while watching such bilingual programs.
- <sup>\*1</sup> Dual Mono signals can be heard from the following speakers—L (left front speaker), R (right front speaker), and C (center speaker)—with respect to the current Surround setting.

Dual Mono Setting	Without Surround		With Surround Activated				
			Center speaker setting				
	L	R	SMALL/LARGE		NONE		
<b>MAIN</b>	Ch 1	Ch 1	—	Ch 1	—	Ch 1	Ch 1
<b>SUB</b>	Ch 2	Ch 2	—	Ch 2	—	Ch 2	Ch 2
<b>ALL</b>	Ch 1	Ch 2	—	Ch 1+Ch 2	—	Ch 1+Ch 2	Ch 1+Ch 2

## Setting the Digital Input Terminals

When you use the digital input terminals, register which components you have connected to the digital input terminals.

### ■ Digital coaxial terminal—DGTL IN COAX

Set the component connected to the digital coaxial terminal (DIGITAL IN 1).

DVD (initial setting), CD, TV (or DBS\*) or CDR.

\* If you have changed the source name from "TV" to "DBS," "DBS" appears (see page 19).

### ■ Digital optical terminals—DGTL IN OPTICAL

As you set the components connected to the digital coaxial terminal (DIGITAL IN 1), the optical terminals (DIGITAL IN 2 – 4) will be automatically fixed to connect the components listed below.

When "DIGITAL IN 1 (DGTL IN COAX)" is set to "DVD"

2: CD      3: TV (or DBS\*)      4: CDR

When "DIGITAL IN 1 (DGTL IN COAX)" is set to "CD"

2: DVD      3: TV (or DBS\*)      4: CDR

When "DIGITAL IN 1 (DGTL IN COAX)" is set to "TV" or "DBS"\*

2: DVD      3: CD      4: CDR

When "DIGITAL IN 1 (DGTL IN COAX)" is set to "CDR"

2: DVD      3: CD      4: TV (or DBS\*)

\* If you have changed the source name from "TV" to "DBS," "DBS" appears (see page 19).

## Setting the Component Video Input

When you use the component video inputs for connecting the DVD player and/or DBS tuner, register the type of input jacks.

If you have not selected appropriate video input jacks, the AV COMPU LINK remote control system cannot operate properly. (See page 40.)

### ■ For the DVD player—VIDEO IN DVD

Select one of the following:

**COMPNT:** Select when connecting the DVD player to the component video input jacks.

**S/C:** Select when connecting the DVD player to the composite video or S-video input jacks.

### ■ For the DBS tuner—VIDEO IN DBS

Select one of the following:

**COMPNT:** Select when connecting the DBS tuner to the component video input jacks.

**S/C:** Select when connecting the DBS tuner to the composite video or S-video input jacks.

## Memorizing the Volume Level for Each Source

This unit memorizes some settings separately for each source. In addition, you can store the volume level for each source with the other memorized settings—One Touch Operation.

### ■ One Touch Operation—ONE TOUCH OPE

Select one of the following:

**ON:** Select to store the volume level separately for each source. (The ONE TOUCH OPERATION indicator lights up on the display.)

This receiver memorizes the volume level—

- when you change the source, or
- when you change the source name.

**OFF:** Select this not to store the volume level.

#### To recall the volume level

With the ONE TOUCH OPERATION indicator lit, the volume level for the currently selected source is recalled when the source is selected.

#### To cancel the One Touch Operation

Set One Touch Operation to "OFF" so that the ONE TOUCH OPERATION indicator goes off.

# Adjusting Sound

You can make sound adjustment to your preference after completing basic setting.

## Basic Setting Items

- On the following pages, you can adjust the items listed below:
- You can adjust only the items applicable to the current sound mode.
  - If Analog Direct is in use, you cannot make any sound adjustments.

Items	To do	See page
<b>DIGITAL EQ</b>	Adjust equalizer pattern.	30
<b>SUBWFR LVL</b>	Adjust the subwoofer output level.	30
<b>FRONT L LVL</b>	Adjust the left front speaker output level.	30
<b>FRONT R LVL</b>	Adjust the right front speaker output level.	30
<b>CENTER LVL</b>	Adjust the center speaker output level.	30
<b>SURR L LVL</b>	Adjust the left surround speaker output level.	30
<b>SURR R LVL</b>	Adjust the right surround speaker output level.	30
<b>SBACK LVL</b>	Adjust the surround back speaker output level.	30
<b>EFFECT*<sup>1</sup></b>	Adjust the DAP effect level.	31
<b>ROOMSIZE*<sup>1</sup></b>	Select the room size for your virtual listening room.	31
<b>LIVENESS*<sup>1</sup></b>	Select the liveness level for your virtual listening room.	31
<b>CTR TONE</b>	Make the center tone soft or sharp.	31
<b>PANORAMA*<sup>2</sup></b>	Add “wraparound” sound effect with side-wall image.	31
<b>CNTR WIDTH*<sup>2</sup></b>	Adjust the center channel localization between the center speaker and the left/right front speakers.	31
<b>DIMENSION*<sup>2</sup></b>	Adjust sound localization position.	31
<b>CNTR GAIN*<sup>3</sup></b>	Adjust sound localization of the center channel.	31

### Notes:

- \*<sup>1</sup> Adjustable when the DAP mode is in use.  
 \*<sup>2</sup> Adjustable when Pro Logic II Music is in use.  
 \*<sup>3</sup> Adjustable when Neo:6 Music is in use.

## Basic Procedure

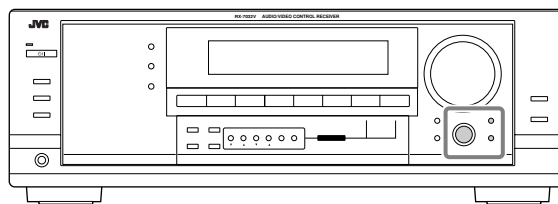

### Before you start, remember...

There is a time limit in doing the following steps. If the setting is canceled before you finish, start from step 1 again.

Ex. When adjusting the subwoofer level to “-3.”

### 1. Press ADJUST.

The last selected item appears on the display.

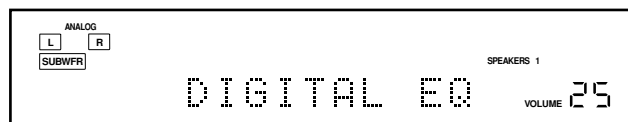

### 2. Turn MULTI JOG until an item you want appears on the display.

- In this example, select “SUBWFR LVL.” For available items, see the list to the left.



### 3. Press in MULTI JOG (PUSH SET).

The current setting (or level) for the selected item appears on the display.



### 4. Turn MULTI JOG to select a setting you want or to make an adjustment as you like.



### 5. Press EXIT.

### 6. Repeat steps 2 to 5 to set other items if necessary.

### 7. Press EXIT.

The source indication resumes on the display.

## Adjusting the Equalization Patterns

You can adjust the equalization patterns to your preference.

- Once you have made adjustment, it is memorized for each source.

### ■ **Equalization adjustment—DIGITAL EQ**

You can adjust five frequency bands (**center frequency: 63 Hz, 250 Hz, 1 kHz, 4 kHz, 16 kHz**) within the range of **-8 dB to +8 dB** (“0 dB” is the initial setting) in 2 dB steps.

- When adjustment is made, the DIGITAL EQ indicator lights up on the display.

**To flat the equalization pattern**, set all the frequency bands to “0 dB” in step 4 of “Basic Procedure” (on page 29). The DIGITAL EQ indicator goes off from the display.

### **Notes:**

- When Analog Direct is in use, Digital Equalization patterns are not available.
- The Digital Equalization affects the front speaker sounds only.

You can also use the remote control for equalization adjustment.

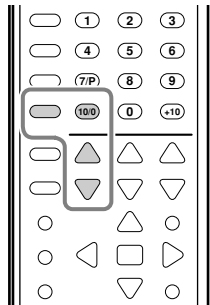

- 1. Press SOUND.**  
The 10 keys are activated for sound adjustments.
- 2. Press DIGITAL EQ (Equalization) repeatedly to select the center frequency you want to adjust.**
  - Each time you press the button, the center frequency with its current level appear on the display
- 3. Press LEVEL + or - repeatedly to adjust the level of the center frequency.**  
The DIGITAL EQ indicator lights up on the display.
  - The frequency level changes from -8 dB to +8 dB in 2 dB steps.
- 4. Repeat steps 2 and 3 to adjust the other center frequency.**

## Adjusting the Speaker Output Levels

You can adjust the speaker output levels. The test tone comes out of each speaker except subwoofer to check the output level balance when using the Surround mode.

- Once you have made an adjustment, it is memorized for each source.

### ■ **Adjustable speakers**

You can adjust the following speakers' output levels within the range of **-10 dB to +10 dB** (“0 dB” is the initial setting):

<b>SUBWFR LVL:</b>	Select to adjust the subwoofer output level.
<b>FRONT L LVL:</b>	Select to adjust the left front speaker output level.
<b>FRONT R LVL:</b>	Select to adjust the right front speaker output level.
<b>CENTER LVL:</b>	Select to adjust the center speaker output level.
<b>SURR L LVL:</b>	Select to adjust the left surround speaker output level.
<b>SURR R LVL:</b>	Select to adjust the right surround speaker output level.
<b>SBACK LVL:</b>	Select to adjust the surround back speaker output level.

### **Notes:**

- If you have selected “NO” or “NONE” for a speaker (see page 25), the output level for the corresponding speaker is not adjustable.
- The center speaker, and left/right surround speakers' output levels are adjustable for DVD MULTI playback mode, even though “NONE” is selected for the speaker settings.
- Speaker output levels (except the subwoofer output level) are not adjustable when Analog Direct is in use. To adjust subwoofer output level, see page 17.



You can also use the remote control for adjusting the speaker output level.

When using the remote control, you can make an adjustment while listening to test tone.

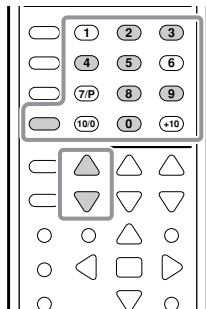

**1. Press SOUND.**

The 10 keys are activated for sound adjustments.

**2. Press TEST to check if you can hear the sounds through all the speakers at equal level.**

Test tone comes out of the speakers in the following order.

- No test tone comes out of the speakers which are set to “NONE” in the speaker setting, and the subwoofer.

FRNT L (Left front speaker) → CENTER (Center speaker) →  
 FRNT R (Right front speaker) →  
 SURR R (Right surround speaker) →  
 SBACK (surround back speaker) →  
 SURR L (Left surround speaker) → (Back to the beginning)

**3. Select a speaker you want to adjust.**

- To select the left front speaker, press FRONT•L.
- To select the center speaker, press CENTER.
- To select the right front speaker, press FRONT•R.
- To select the right surround speaker, press SURR•R.
- To select the surround back speaker, press SURR BACK.
- To select the left surround speaker, press SURR•L.

**4. Press LEVEL + or – to adjust the speaker output level (-10 dB to +10 dB).**

**5. Repeat steps 3 and 4 to adjust the other speaker’s output levels.**

**6. Press TEST again to stop the test tone.**

## Adjusting the Sound Parameters for the Surround and DSP Modes

You can adjust the Surround and DSP sound parameters to your preference.

- When center speaker is set to “NONE,” CTR TONE, CNTR WIDTH, and CNTR GAIN are not available.

■ **Adjustable parameters**

You can adjust the following parameters:

**For Surround, DAP, and All Channel Stereo modes (when the center speaker is connected)**

- **This setting is common to all surround modes, and is memorized separately for DSP modes.**

---

**CTR TONE:** Adjust the center tone. As the number increases, the dialogue becomes clearer so that the human voices change from soft to sharp. Normally select “3 (initial setting).”  
Adjustable range: **1 to 5**

---

**For DAP modes**

- Once you have made an adjustment, it is memorized for each DAP mode.

---

**EFFECT:** Adjust the DAP effect level. As the number increases, the DAP effect becomes stronger. Normally select “3 (initial setting).”  
Adjustable range: **1 to 5**

---

**ROOMSIZE:** Adjust the virtual room size. As the number increases, the interval between reflections increases so that you will feel as if you were in a larger room. Normally select “3 (initial setting).”  
Adjustable range: **1 to 5**

---

**LIVENESS:** Adjust the liveness effect. As the number increases, the attenuation level of reflections over time decreases so that acoustics change from “Dead” to “Live.” Normally select “3 (initial setting).”  
Adjustable range: **1 to 5**

---

**For Pro Logic II Music only**

**PANORAMA:** Select “ON” to add “wraparound” sound effect with side-wall image. (Initial setting: “OFF”)

---

**CNTR WIDTH:** Adjust the center channel localization between the center speaker and the left/right front speakers. As the number increases, the center channel sound moves toward the left and right front speakers. Normally select “3 (initial setting).”  
Adjustable range: **OFF and 1 to 7**

---

**DIMENSION:** Adjust sound localization position. As the number increases, the sound localization moves towards forward from backward. Normally select “4 (initial setting).”  
Adjustable range: **1 to 7**

---

**For Neo:6 Music only**

**CNTR GAIN:** Adjust the sound localization of the center channel. As the number increases, center channel will be localized clearly. Normally select “0.2 (initial setting).”  
Adjustable range: **0 to 0.5**

---

# Using the Surround Modes

This unit activates a variety of Surround modes automatically. The basic settings and adjustments stored (see pages 23 to 31) are applied.

## Reproducing Theater Ambience

In a movie theater, many speakers are located on the walls to reproduce impressive multi-surround sounds, reaching you from all directions.

With these many speakers, sound localization and sound movement can be expressed.

Surround modes built in this receiver can create almost the same surround sounds as you can feel in a real movie theater—with only five to seven speakers (plus subwoofer).

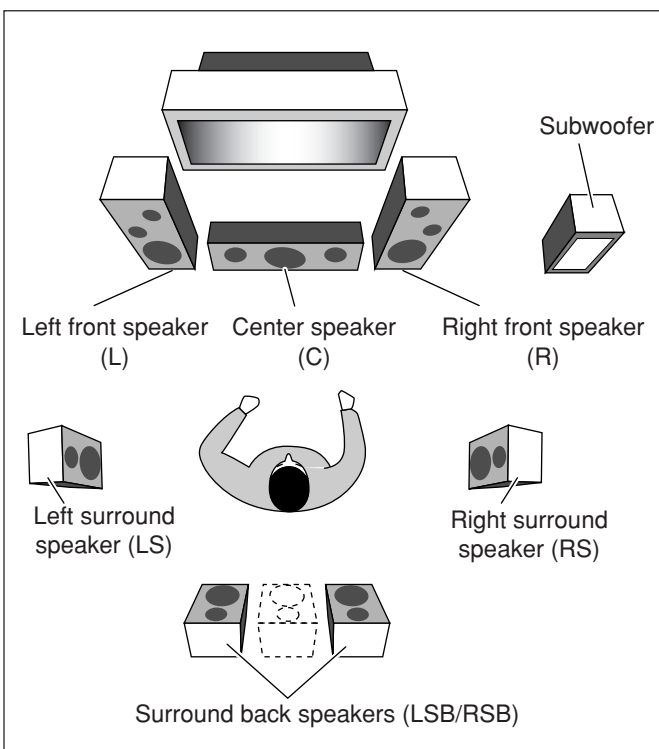
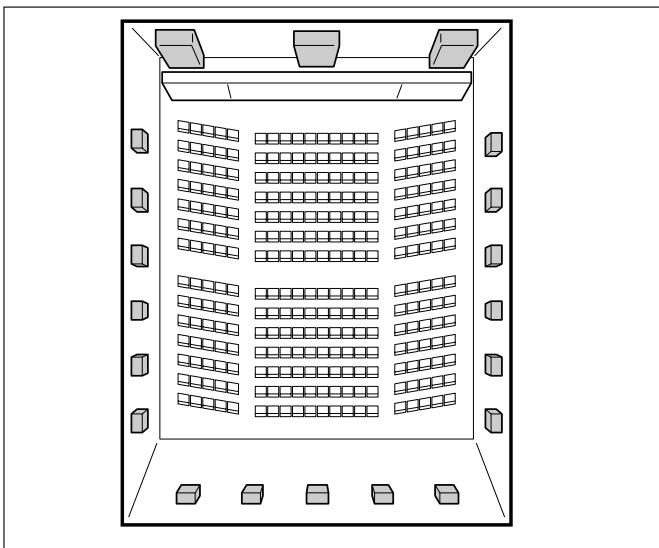

## Introducing the Surround Modes

### Dolby Digital\*<sup>1</sup>

Dolby Digital is a digital signal compression method, developed by Dolby Laboratories, and enables multi-channel encoding and decoding (1ch up to 5.1ch).

- When Dolby Digital signal is detected through the digital input, the  indicator lights up on the display.

### Dolby Digital 5.1CH

Dolby Digital 5.1CH (DOLBY D) encoding method records and digitally compresses the left front channel, right front channel, center channel, left surround channel, right surround channel, and LFE channel signals (total 6 channels, but the LFE channel is counted as 0.1 channel. Therefore, called 5.1 channel).

Dolby Digital enables stereo surround sounds, and sets the cutoff frequency of the surround treble at 20 kHz, compared to 7 kHz for Dolby Pro Logic. As such, the sound movement and “being-there” feeling are enhanced much more than Dolby Pro Logic.

### Dolby Digital EX

Dolby Digital EX (DOLBY D EX) is a digital surround encoding format that adds the third surround channels, called “surround back.”

Compared to the conventional Dolby Digital 5.1CH, these newly added surround back channels can reproduce more detailed movements behind you while viewing the video software. In addition, surround sound localization will become more stable.

- You can use Virtual 6.1-channel surround when playing back Dolby Digital EX software without connecting the surround back speakers. This surround reallocates the surround back channel to the surround speakers so that you can still feel the great surround effect from behind.

The VIRTUAL SB (Surround Back) indicator lights up on the display.

### Dolby Pro Logic

Dolby Surround encoding format records the left front channel, right front channel, center channel, and surround channel (monaural) signals into 2 channels.

The Dolby Pro Logic (PRO LOGIC) decoder built in this receiver decodes these 2 channel signals into 4 original channel signals (plus subwoofer)—matrix-based multi-channel reproduction.

- When Dolby Pro Logic is activated, the  indicator lights up on the display.

## Dolby Pro Logic II

Dolby Pro Logic II is a multi-channel playback format to convert 2-channel software into 5-channel (plus subwoofer). The matrix-based conversion method used for Dolby Pro Logic II makes no limitation for the cutoff frequency of the surround treble and enables stereo surround sound.

- This receiver provides two types of Dolby Pro Logic II modes—**Pro Logic II Movie** (PLII MOVIE) and **Pro Logic II Music** (PLII MUSIC).

When Dolby Pro Logic II is activated, the  **PRO LOGIC II** indicator lights up on the display.

---

**PLII MOVIE:** Suitable for playing any Dolby Surround encoded software. You can enjoy a sound field very close to the one created with discrete 5.1-channel sounds.

---

**PLII MUSIC:** Suitable for playing any 2-channel stereo software. You can enjoy wide and deep sounds.

---

## DTS\*2

DTS is another digital signal compression method, developed by Digital Theater Systems, Inc., and enables multi-channel encoding and decoding (1ch up to 6.1ch).

- When DTS signal is detected through the digital input, the  indicator lights up on the display.

## DTS Digital Surround

DTS Digital Surround (DTS) is another discrete 5.1 channel digital audio format available on CD, LD, and DVD software.

Compared to Dolby Digital, the DTS Digital Surround format has a lower audio compression rate which enables it to add breadth and depth to the sounds reproduced. As such, DTS Digital Surround features natural, solid, and clear sound.

- When EX/ES setting is set to “ON,” DTS Neo:6 (DTS NEO:6) is applied while playing back multi-channel DTS software. It creates the same surround ambience as 6.1-channel software does.

## DTS Extended Surround (DTS-ES)

DTS-ES is another multi-channel digital encoding format.

It greatly improves the 360-degree surround impression and space expression by adding the third surround channel—surround back channel.

DTS-ES includes two signal formats with different surround signal recording methods—**DTS-ES Discrete 6.1ch** (ES DSCRETE) and **DTS-ES Matrix 6.1ch** (ES MATRIX).

**DTS-ES Discrete 6.1ch** has been designed to encode (and decode) a 6.1-channel signal discretely to avoid interference with each channel.

**DTS-ES Matrix 6.1ch** has been designed to add an extra surround channel to DTS Digital Surround 5.1-channel. By using a matrix encoding/decoding method, an additional “surround back” channel signal is encoded (and decoded) in both the left and right surround channel signals.

- You can use Virtual 6.1-channel surround when playing back DTS-ES software without connecting the surround back speakers. This surround reallocates the surround back channel to the surround speakers so that you can still feel the great surround effect from behind. The VIRTUAL SB (Surround Back) indicator lights up on the display.

## DTS 96/24

In recent years, there has been increasing interest in higher sampling rates both for recording and for reproducing at home. Higher sampling rates allow wider frequency range and greater bit depths provide extended dynamic range.

DTS 96/24 is a multi-channel digital signal format (fs 96 kHz/24 bits) introduced by Digital Theater Systems, Inc. to deliver “better-than-CD sound quality” into the home.

- When DTS 96/24 signal is detected, the 96/24 indicator lights up. You can enjoy its 5.1-channel sound with full-quality.

## DTS Neo:6

DTS Neo:6 is another conversion method to create 6-channel (plus subwoofer) from analog/digital 2-channel software by using the high precision digital matrix decoder used for DTS-ES Matrix 6.1ch.

When one of Neo:6 modes is activated, the NEO:6 indicator lights up on the display.

- This receiver provides the following DTS NEO:6 modes—**Neo:6 Cinema** (NEO:6CINMA) and **Neo:6 Music** (NEO:6MUSIC).

---

**NEO:6CINMA:** Suitable for playing movies. You can get the same atmosphere with 2-channel software as with 6.1-channel software. It is also effective for playing software encoded with conventional surround formats.

---

**NEO:6MUSIC:** Suitable for playing music software. The front channel signals bypass the decoder (resulting in no loss of sound quality) and the surround signals transmitted through the other speakers expand the sound field naturally.

---

### What is Dual Mono?

Dual Mono can be easily understood when you think of the bilingual broadcast for TV programs (however, the Dual Mono format is not identical with those analog formats).

This format is now adopted in Dolby Digital, DTS, and so on. It allows two independent channels (called main channel and sub-channel) to be recorded separately.

- When Dual Mono signal is detected, the DUAL indicator lights up. You can select either channel you want to listen to (see page 27).

**When using the Surround mode, the sounds come out of the activated speakers which the Surround mode requires.**

- **If the surround speakers and center speaker are set to “NONE” in the speaker setting, JVC’s original 3D-PHONIC processing (which has been developed to create the surround effect through the front speakers only) is used.** The 3D-PHONIC indicator lights up on the display.

\*1 *Manufactured under license from Dolby Laboratories. “Dolby,” “Pro Logic,” and the double-D symbol are trademarks of Dolby Laboratories.*

\*2 *“DTS,” “DTS-ES Extended Surround” and “Neo:6” are trademarks of Digital Theater Systems, Inc.*

## Surround Modes Applicable to the Various Software

Available Surround modes vary depending on the speaker settings and the incoming signals.

The table below shows the relation of the Surround modes and the incoming signals (with the surround back speakers and EX/ES setting).

- The numbers inside the parentheses following the incoming signal type indicate the number of the front channels and that of the surround channels. For example, (3/2) indicates that the signals are encoded with three front signals (left/right/center) and two (stereo) surround signals.

Incoming Signal Type	Surround Back Channel Setting	EX/ES Setting	Available Surround Mode
Dolby Digital EX	2SPK/1SPK	AUTO/ON	DOLBY D EX
		OFF	DOLBY D
	NONE	AUTO/ON	DOLBY D (VIRTUAL SB)*1
		OFF	DOLBY D
Dolby Digital (3/2, 2/2)	2SPK/1SPK	AUTO	DOLBY D
		ON	DOLBY D EX
		OFF	DOLBY D
	NONE	Not available	DOLBY D
Dolby Digital (3/1, 2/1)	2SPK/1SPK	AUTO/ON/OFF	DOLBY D
	NONE	Not available	DOLBY D
Dolby Digital (1/0, 3/0)	2SPK/1SPK/NONE	Not available	DOLBY D
Dolby Digital (Dual Mono)	2SPK/1SPK/NONE	Not available	DUAL MONO
DTS-ES Discrete 6.1ch	2SPK/1SPK	AUTO/ON	ES DSCRETE
		OFF	DTS
	NONE	AUTO/ON	DTS (VIRTUAL SB)*1
DTS-ES Matrix 6.1ch DTS-ES 96/24 Matrix	2SPK/1SPK	AUTO/ON	ES MATRIX*2
		OFF	DTS
	NONE	AUTO/ON	DTS (VIRTUAL SB)*1 *2
		OFF	DTS
DTS, DTS 96/24 (3/2, 2/2)	2SPK/1SPK	AUTO	DTS
		ON	DTS NEO:6*2
		OFF	DTS
	NONE	Not available	DTS
DTS (3/1, 2/1)	2SPK/1SPK	AUTO/ON/OFF	DTS
	NONE	Not available	DTS
DTS (1/0, 3/0)	2SPK/1SPK/NONE	Not available	DTS
DTS (Dual Mono)	2SPK/1SPK/NONE	Not available	DUAL MONO

\*2 DTS 96/24 processing is not applied. If you want to apply the processing, set the EX/ES setting to "OFF."

Incoming Signal Type	Available Surround Mode
Analog/PCM/Dolby Digital (2/0)/DTS (2/0)	PLII MOVIE / PLII MUSIC / PRO LOGIC / NEO:6 CINMA / NEO:6 MUSIC
DVD MULTI	None

### 3D HEADPHONE Mode—3D H PHONE

You can also enjoy the Surround modes through the headphones.

If you press SURROUND when the front speakers 1 and 2 are both deactivated, 3D HEADPHONE mode (3D H PHONE) is activated without respect to the type of software played back. "3D H PHONE" appears on the display and the DSP and HEADPHONE indicators also light up.

#### \*1 Virtual 6.1-channel surround

If you have connected (and activated) the surround speakers, you can use Virtual 6.1-channel surround when playing back Dolby Digital EX or DTS-ES software without connecting the surround back speakers. This surround reallocates the surround back channel to the surround speakers so that you can still feel the great surround effect from behind. The VIRTUAL SB (Surround Back) indicator lights up on the display.

## Activating the Surround Modes

Available Surround modes vary depending on the speaker settings and the incoming signals. (See page 32.)

Activating one of the Surround modes for a source automatically recalls the memorized settings and adjustments (see pages 23 to 31.)

You can also use the buttons on the remote control for the same functions.

### Activating the EX/ES setting

For multi-channel digital software, you can activate the EX/ES (7.1-channel) reproduction mode.

- Once you have set EX/ES (7.1-channel) reproduction mode, it is stored in memory and will be called up whenever you activate the Surround mode which the memorized EX/ES (7.1-channel) reproduction mode can be applied to.

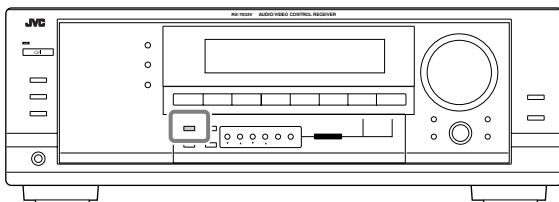

Press EX/ES to select an appropriate setting for your enjoyment.

The currently selected EX/ES (7.1-channel) reproduction mode appears on the display.

- Each time you press the button, it changes as follows:

**EX/ES AUTO\*:** According to the incoming signal, an appropriate Surround mode is applied.

- For Dolby Digital EX and DTS-ES, EX/ES (7.1-channel) reproduction is applied.
- For 5.1-channel (or less) encoded software, 5.1-channel reproduction is applied.

**EX/ES ON\*:** Select to apply EX/ES (7.1-channel) reproduction to both 5.1-channel and 6.1-channel encoded software.

**EX/ES OFF:** Select to cancel the EX/ES (7.1-channel) reproduction.

\* If the surround back speakers are not connected or deactivated, Virtual 6.1-channel surround is applied.

#### Notes:

- When Surround mode is deactivated, pressing EX/ES will activate an appropriate Surround mode for the current source.
- When an analog or digital 2-channel source is playing, you can adjust the EX/ES (7.1-channel) reproduction mode and store the setting, but it will not affect the current source.
- When the source is one to which the EX/ES (7.1-channel) reproduction cannot be applied, you can adjust the setting and store in memory, but reproduction channels will remain unchanged.

## Activating the Surround Modes

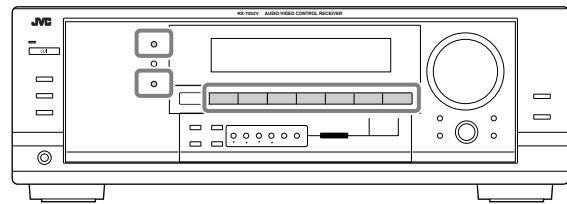

### 1. Select and play any source other than "DVD MULTI."

- Make sure you have selected the analog or digital input mode.
- Surround modes are not valid for DVD MULTI playback mode.

### 2. Press SURROUND to activate the Surround mode.

- For multi-channel digital software (except 2-channel and Dual Mono software), incoming signals are automatically detected and the appropriate surround mode is activated (see page 34 for details).

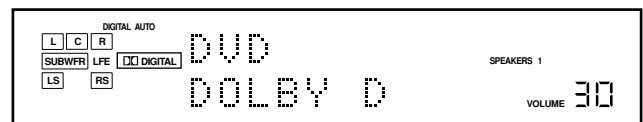

Ex. When "DOLBY D" is activated.

- If the EX/ES (7.1-channel) reproduction mode has been set to "AUTO" or "ON," one of the EX/ES (7.1-channel) reproduction modes will be activated (see the left column).

- For analog sources and digital 2-channel software, you can select one of the following Surround modes. Each time you press SURROUND, Surround modes change as follows:

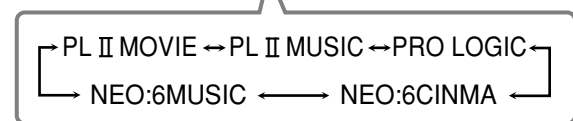

- For Dual Mono software, you can select the channel you listen to. (See page 27.)

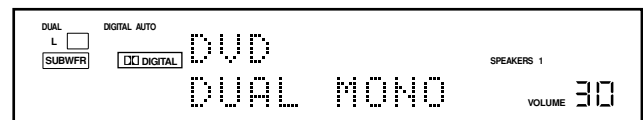

To adjust the speaker output level, see pages 30 and 31.

### To cancel the Surround mode

Press SURROUND/DSP OFF (or SURR/DSP OFF on the remote control). "SURR OFF" appears on the display.

# Using the DSP Modes

This unit activates a variety of DSP modes automatically. The basic settings and adjustments stored (see pages 23 to 31) are applied automatically.

## Reproducing the Sound Field

The sound heard in a concert hall, club, etc. consists of direct sound and indirect sound—early reflections and reflections from behind. Direct sounds reach the listener directly without any reflection. On the other hand, indirect sounds are delayed by the distances of the ceiling and walls. These direct sounds and indirect sounds are the most important elements of the acoustic surround effects. The DSP modes can create these important elements, and give you a real “being there” feeling.

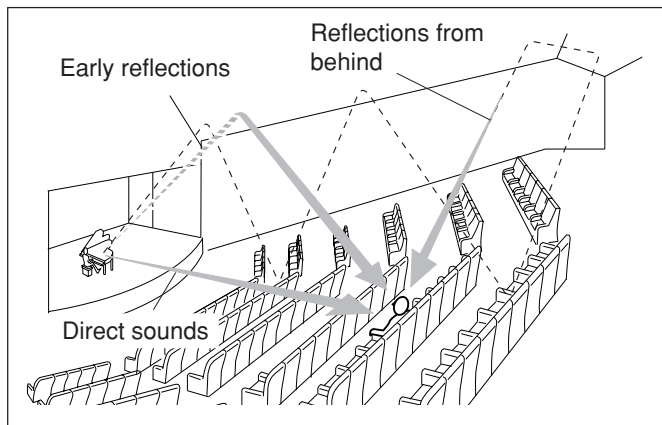

## Introducing the DSP Modes

The DSP modes include the following modes—

- DAP (Digital Acoustic Processor) modes (HALL 1, HALL 2, LIVE CLUB, DANCE CLUB, PAVILION, THEATER 1, THEATER 2)
- ALL CH STEREO
- MONO FILM

### 3D HEADPHONE Mode

You can also enjoy the DSP effect (except All Channel Stereo mode) through the headphones.

If you press DSP when the front speakers 1 and 2 are both deactivated, 3D HEADPHONE mode is activated without respect to the type of software played back. “3D H PHONE” appears on the display and the DSP and HEADPHONE indicators also light up.

To use the DSP modes, press DSP so that the DSP modes change as follows.

The DSP indicator also lights up on the display.

→ HALL 1	→ HALL 2	→ LIVE CLUB
→ DANCE CLUB	→ PAVILION	→ ALL STEREO
→ THEATER 1	→ THEATER 2	→ MONO FILM
→ (Back to the beginning)		
<input type="checkbox"/> : Suitable for audio sources <input type="checkbox"/> : Suitable for video sources		

### DAP modes

You can use the following DAP modes in order to reproduce a more acoustic sound field in your listening room.

<b>HALL 1:</b>	Reproduces the spatial feeling of a large shoebox-shaped hall designed primarily for classical concerts. (Its seating capacity is about 2000.)
<b>HALL 2:</b>	Reproduces the spatial feeling of a large vineyard-shaped hall designed primarily for classical concerts. (Its seating capacity is about 2000.)
<b>LIVE CLUB:</b>	Reproduces the spatial feeling of a live music club with a low ceiling.
<b>DANCE CLUB:</b>	Reproduces the spatial feeling of a rocking dance club.
<b>PAVILION:</b>	Reproduces the spatial feeling of an exhibition hall with a high ceiling.
<b>THEATER 1*:</b>	Reproduces the spatial feeling of a large theater where the seating capacity is about 600.
<b>THEATER 2*:</b>	Reproduces the spatial feeling of a small theater where the seating capacity is about 300.

\* The built-in Dolby Pro Logic II decoder is activated when playing back 2-channel analog or digital source. The **PRO LOGIC II** indicator lights up.

**When using the DAP mode, the sounds come out of all the connected and activated speakers.**

- If surround speakers are set to “NONE” in the speaker setting, JVC’s original 3D-PHONIC processing (which has been developed to create the surround effect through the front speakers only) is used.

The 3D-PHONIC indicator lights up on the display.

**All Channel Stereo mode**

This mode can reproduce a larger stereo sound field using all the connected (and activated) speakers. **This mode cannot be used without activating the surround speakers.**

- If the front speakers are deactivated, "All Channel Stereo" cannot be selected.

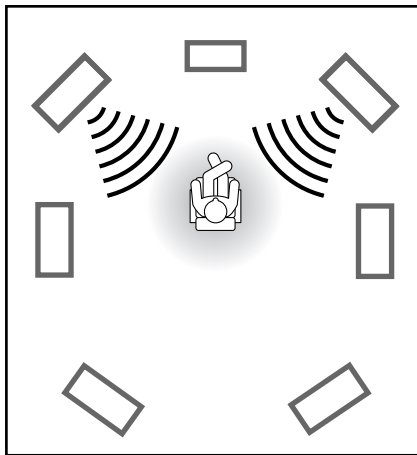

Sound reproduced from normal stereo

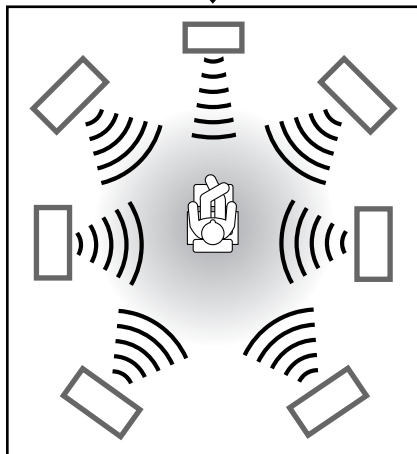

Sound reproduced from All Channel Stereo mode

**Monaural Film**

In order to reproduce a more acoustic sound field in your listening room while viewing monaural sound video software (analog and 2-channel digital signals), you can use this mode.

The surround effect will be added, and the sound localization of actor's words will be improved. **This mode cannot be used for multi-channel digital signals.**

When "MONO FILM" is used, sounds come out of all the connected (and activated) speakers.

- If incoming signals change from 2-channel digital signal to another digital signal type, "MONO FILM" is canceled and an appropriate Surround mode is activated.

**Activating the DSP Modes**

Activating one of the DSP modes for a source automatically recalls the memorized settings and adjustments (see pages 23 to 31.)

You can also use the buttons on the remote control for the same functions.

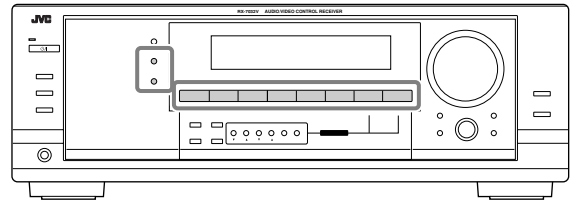

1. Select and play any sound source.
2. Press DSP repeatedly until the DSP mode you want appears on the display.
  - Each time you press the button, the DSP modes change as follows:

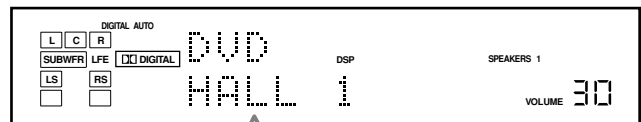

- HALL 1      → HALL 2      → LIVE CLUB
- DANCE CLUB → PAVILION    → ALL STEREO\*
- THEATER 1   → THEATER 2   → MONO FILM\*\*
- (Back to the beginning)

- \* When surround speakers are set to "NONE," you cannot select "ALL STEREO."
- \*\* When multi-channel signals come in, you cannot select "MONO FILM."

**Note:**

When the surround speakers are deactivated, the 3D-PHONIC processing is applied to the DSP modes (the 3D-PHONIC indicator also lights up).

**To cancel the DSP modes**

- Press SURROUND/DSP OFF (or SURR/DSP OFF on the remote control). "SURR OFF" appears on the display.
- When the front speakers are deactivated, "HEADPHONE" will appear.

# Using the DVD MULTI Playback Mode

This receiver provides the DVD MULTI playback mode for reproducing the analog discrete output mode of the DVD player.

## Connection diagram

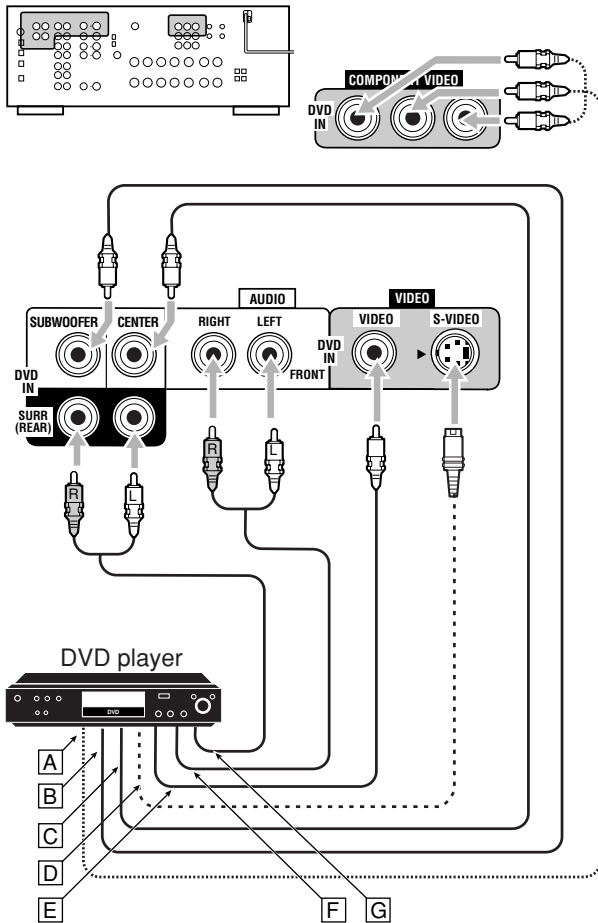

- A To component video output
- B To subwoofer output
- C To center channel audio output
- D To S-video output
- E To composite video output
- F To left/right front channel audio output
- G To left/right surround channel audio output

### Note:

When connecting a DVD player to the component video input jacks, make the component video input setting correctly. See page 28 for details.

## Activating the DVD MULTI Playback Mode

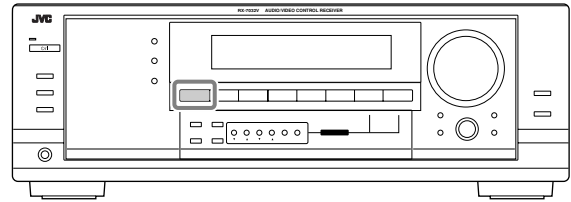

1. Press DVD MULTI so that "DVD MULTI" appears on the display.

The MULTI indicator also lights up.

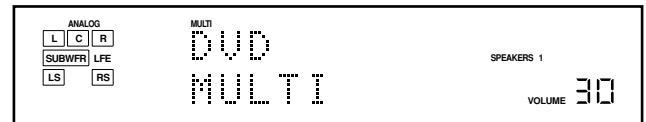

### Note:

When you select "DVD MULTI" as the source to play, the Surround and DSP modes are canceled, and the SURROUND and DSP buttons do not work.

2. Select the analog discrete output mode on the DVD player, and start playing a DVD.

- Refer also to the manual supplied with the DVD player.

You can adjust Digital Equalization patterns and speaker output levels. See page 30 for details.

### Notes:

- Midnight Mode is not available for DVD MULTI playback mode (see page 18).
- When using the headphones, you can listen to the front channels (left and right) only.



# COMPU LINK Remote Control System

The COMPU LINK remote control system allows you to operate JVC's audio components through the remote sensor on the receiver.

To use this remote control system, you need to connect JVC's audio components through the COMPU LINK (SYNCHRO) jacks (see below) in addition to the connections using cables with RCA pin plugs (see page 10).

- Make sure that the AC power cords of these components are unplugged before connection. Plug the AC power cords only after all connections are complete.

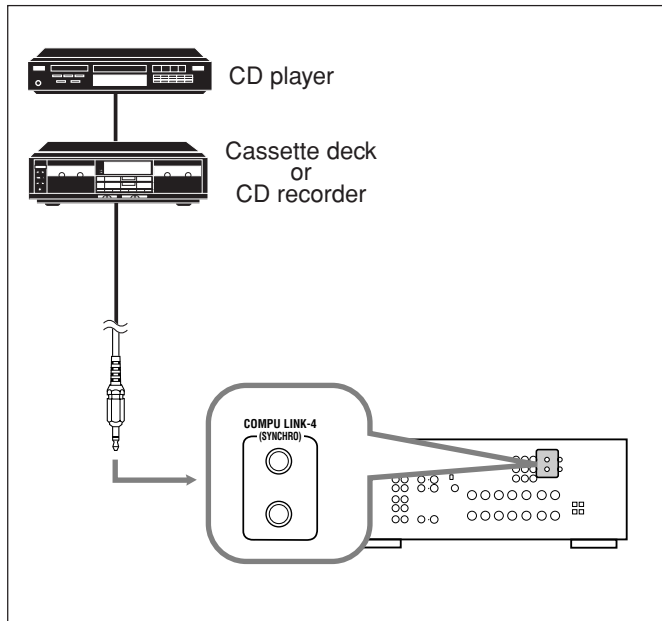

## Notes:

- There are four versions of COMPU LINK remote control system. This receiver is equipped with the fourth version—COMPU LINK-4. This version is added systematic operations with the CD recorder to the previous version—COMPU LINK-3.
- If your audio component has two COMPU LINK jacks, you can use either one. If it has only one COMPU LINK jack, connect it so that it is the last item in the series of components.
- To operate the target component using the COMPU LINK remote control system, set the source name correctly if required. (See page 19.)
- Refer also to the manuals supplied with your audio components.

This remote control system allows you to use four functions listed below.

## Remote Control through the Remote Sensor on the Receiver

You can control the connected audio components through the remote sensor on the receiver using this remote control. Aim the remote control directly at the remote sensor on the receiver. For details, see pages 42 and 43.

## Automatic Source Selection

When you press the play (▶) button on a connected component or on its own remote control, the receiver automatically turns on and changes the source to the component. On the other hand, if you select a new source on the receiver or on the remote control, the selected component begins playing immediately.

In both cases, the previously selected source continues playing without sound for a few seconds.

- You cannot use the COMPU LINK remote control system to operate the MD recorder.

## Automatic Power On/Off (Standby)—only possible with the COMPU LINK-3 and COMPU LINK-4

The connected components turn on and off (standby) along with the receiver.

When you turn on the receiver, one of the connected components will turn on automatically, depending on which component has been previously selected.

When you turn off the receiver, the connected components will turn off (standby).

## Synchronized Recording

Synchronized recording means the cassette deck starts recording as soon as a CD begins playing.

To use synchronized recording, follow these steps:

1. Put a tape in the cassette deck, and a disc in the CD player.
2. Press the record (●) button and the pause (II) button on the cassette deck at the same time. This puts the cassette deck into recording pause. If you do not press the record (●) button and pause (II) button at the same time, the synchronized recording feature will not operate.
3. Press the play (▶) button on the CD player. The source changes on the receiver, and as soon as play starts, the cassette deck starts recording. When the play ends, the cassette deck enters recording pause, and stops about 4 seconds later.

## Notes:

- During synchronized recording, the selected source cannot be changed.
- If the power of any component is shut off during synchronized recording, the COMPU LINK remote control system may not operate properly. In this case, you must start again from the beginning.

# AV COMPU LINK Remote Control System

The AV COMPU LINK remote control system allows you to operate JVC's video components (TV, VCR, and DVD player) through the receiver.

This receiver is equipped with the AV COMPU LINK-III, which adds a function to the previous version in order to operate JVC's video components through the video components terminals. To use this remote control system, connect the video components you want to operate, following the diagrams below and the procedure on the next page.

## CONNECTIONS 1: AV COMPU LINK Connection

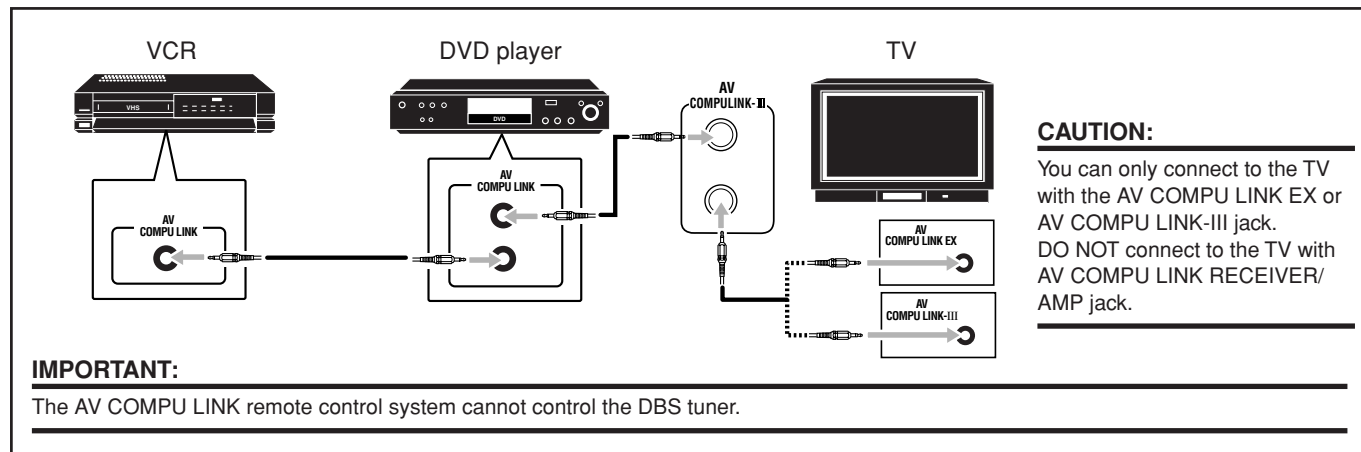

### Notes:

- When connecting the receiver and a TV with the AV COMPU LINK EX terminal by using a component video cable, you cannot use automatic selection of TV's input mode (see page 41).
- When connecting only the VCR or DVD player to this receiver, connect it directly to the receiver using cables with the monaural mini-plugs.

## CONNECTIONS 2: Video Cable Connection

This receiver is equipped with three types of the video terminals—S-video, composite video, and component video, and the signals coming into this receiver through one type of video jacks can output only through the jack of the same type. So you need to connect the VCR and/or DVD player to the TV using one of the following three ways:

- When using the AV COMPU LINK remote control system, set the component video input for the DVD player and the DBS tuner correctly (see "Setting the Component Video Input" on page 28); otherwise, the correct input for this receiver will not be selected on the TV.

CASE 1	<p>When connecting the source equipment to the receiver through the <b>S-video jacks</b>, connect this receiver to the TV's Video Input 1 jack using S-video cables.</p>
CASE 2	<p>When connecting the source equipment to the receiver through the <b>composite video jacks</b>, connect this receiver to the TV's Video Input 2 jack (composite video input) using composite video cables.</p>
CASE 3	<p>When connecting the source equipment to the receiver through the <b>component video jacks</b>, connect this receiver to the TV's Video Input 2 jack (component video input) using component video cables.</p>

1. **If you have already plugged your VCR , DVD player, TV and this receiver into the AC outlets, unplug their AC power cords first.**
2. **Connect your VCR, DVD player, TV and this receiver, using the cables with the monaural mini-plugs (not supplied).**
  - See “CONNECTIONS 1” on the previous page.
3. **Connect the audio input/output jacks on VCR, DVD player, TV and this receiver using the cables with RCA pin plugs.**
  - See pages 12 and 13.
4. **Connect the video input/output jacks on VCR, DVD player, TV and this receiver, using the cables with RCA pin plugs, S-video plug or component video plugs.**
  - See “CONNECTIONS 2” on the previous page.
5. **Plug the AC power cords of the components and the receiver into the AC outlets.**
6. **When turning on the TV for the first time after the AV COMPU LINK connection, turn the TV volume to the minimum using the TV volume control on the TV.**
7. **Turn on the connected components first, then turn on this receiver.**
  - When turning on the VCR, use the remote control supplied with this receiver.

The AV COMPU LINK remote control system allows you to use the five basic functions listed below.

#### **Remote Control of the TV, DVD player, and VCR Using This Remote Control**

See page 44 for details.

- Aim the remote control directly at the remote sensor on each target component.

#### **One-Touch Video Play**

Simply by inserting a video cassette without its safety tab into the VCR, you can enjoy the video playback without setting other switches manually. The receiver automatically turns on and changes the source to “VCR.”

The TV automatically turns on and changes the input mode to the appropriate position so that you can view the playback picture. When you insert a video cassette with its safety tab, press the play (▶) button on the VCR or on the remote control. So, you can get the same result.

#### **One-Touch DVD Play**

Simply by starting playback on the DVD player, you can enjoy the DVD playback without setting other switches manually.

- When the DVD player is connected through the analog input jacks on this receiver (and analog input is selected), the receiver automatically turns on and changes the source to “DVD” or “DVD MULTI.”
  - When the DVD player is connected through the digital input terminal on this receiver (and digital input is selected), the receiver automatically turns on and changes the source to “DVD.”
- The TV automatically turns on and changes the input mode to the appropriate position so that you can view the playback picture.

#### **Automatic Selection of TV's Input Mode**

- When you select “TV” as the source to play on the receiver, the TV automatically changes the input mode to the TV tuner so that you can watch TV.
- When you select any other video source other than “TV” as the source to play on the receiver, the TV automatically changes the input mode to the appropriate position (either Video Input 1 or Video Input 2) so that you can view the playback picture.

#### **Notes:**

- *When you select “TV” as the source on the receiver, you cannot see the menu on the TV screen since the AV COMPU LINK remote control system automatically changes the TV's input mode to the TV tuner.*
- *This function does not work when you connect this receiver and the TV with the AV COMPU LINK EX terminal using a component video cable. In this case, reconnect the TV referring to case 1 or case 2 on page 40.*

#### **Automatic Power On/Off**

**The TV, VCR, and DVD player turn on and off along with the receiver.**

When you turn on the receiver;

- If the previously selected source is “VCR”, the TV and VCR will turn on automatically.
- If the previously selected source is “DVD” or “DVD MULTI,” the TV and DVD player will turn on automatically.
- If the previously selected source is any video source other than the above, only the TV will turn on automatically.

When you turn off the receiver, the TV, VCR and the DVD player will turn off.

#### **Note:**

*If you turn off the receiver while recording on the VCR, the VCR will not turn off, but continue recording.*

# Operating JVC's Audio/Video Components

You can operate JVC's audio and video components with this receiver's remote control, since control signals for JVC's components are preset in the remote control.

## Operating Audio Components

### IMPORTANT:

To operate JVC's audio components using the supplied remote control:

- You need to connect JVC's audio components through the COMPU LINK (SYNCHRO) jacks (see page 39) in addition to the connections using cables with RCA pin plugs (see page 10).
- Aim the remote control directly at the remote sensor on the receiver.
- If you use the buttons on the front panel to choose a source, the remote control will not operate that source. To operate a source with the remote control, the source must be selected using source selection buttons on the remote control.
- To operate the target component using the COMPU LINK remote control system, set the source name correctly if required. (See page 19.)
- Refer also to the manuals supplied with your components.

### Tuner

You can always perform the following operations:

FM/AM: Alternate between FM and AM.

After pressing FM/AM, you can perform the following operations on a tuner:

- 1 – 10/0, +10: Select a preset channel number directly.  
For channel number 5, press 5.  
For channel number 15, press +10, then 5.  
For channel number 20, press +10, then 10/0.

TUNING UP/DOWN:

Tune into stations.

FM MODE: Change the FM reception mode.

### Sound control section (Amplifier)

You can always perform the following operations:

SURROUND: Turn on and select Surround modes  
DSP: Turn on and select DSP modes.  
SURR/DSP OFF: Turn off Surround and DSP modes.

After pressing SOUND, you can perform the following operations:

FRONT•L then LEVEL +/-: Adjust the left front speaker output level.  
FRONT•R then LEVEL +/-: Adjust the right front speaker output level.  
CENTER then LEVEL +/-: Adjust the center speaker output level.  
SURR•L then LEVEL +/-: Adjust the left surround speaker output level.  
SURR•R then LEVEL +/-: Adjust the right surround speaker output level.  
SURR BACK then LEVEL +/-: Adjust the surround back speaker output level.  
SUBWOOFER then LEVEL +/-: Adjust the subwoofer output level.  
DIGITAL EQ then LEVEL +/-: Select the sound frequency bands and adjust its level.  
TEST: Turn on or off test tone output.  
BASS BOOST: Turn on or off Bass Boost.

### Note:

After adjusting sounds, press the corresponding source selection button to operate your target source by using the 10 keys; otherwise, the 10 keys cannot be used for operating your target source.

### CD player

After pressing CD, you can perform the following operations on a CD player:

- ▶: Start playing.  
◀◀: Return to the beginning of the current (or previous) track.  
▶▶: Skip to the beginning of the next track.  
■: Stop playing.  
||: Pause playing. To resume, press ▶.  
1 – 10/0, +10: Select a track number directly.  
For track number 5, press 5.  
For track number 15, press +10, then 5.  
For track number 20, press +10, then 10/0.  
For track number 30, press +10, +10, then 10/0.

### CD changer

After pressing CD DISC, you can perform the following operations on a CD changer:

- ▶: Start playing.
- ◀◀: Return to the beginning of the current (or previous) track.
- ▶▶: Skip to the beginning of the next track.
- : Stop playing or recording.
- ||: Pause playing. To resume, press ▶.
- 1 – 6, 7/P: Select the number of a disc installed in a CD changer.

After pressing CD, you can perform the following operations on a CD changer:

- 1 – 10/0, +10: Select a track number directly.
  - For track number 5, press 5.
  - For track number 15, press +10, then 5.
  - For track number 20, press +10, then 10/0.
  - For track number 30, press +10, +10, then 10/0.

Example:

- Selecting disc number 4, track number 12, and starting playback.
  1. Press CD DISC, then press 4.
  2. Press CD, then press +10, 2.

If your CD changer is of 200-disc loading capability (except for XL-MC100 and XL-MC301), you can do the following operations using the 10 keys after pressing CD.

1. Select a disc number.
2. Then select a track number (always enter two digits).
3. Start playback.

Examples:

- Selecting disc number 3, track number 2, and starting playback. Press 3, then 0, 2, then ▶.
- Selecting disc number 10, track number 5, and starting playback. Press 1, 0, then 0, 5, then ▶.
- Selecting disc number 105, track number 12, and starting playback. Press 1, 0, 5, then 1, 2, then ▶.

### CD recorder

After pressing TAPE/CDR (or TAPE/CDR CONTROL), you can perform the following operations on a CD recorder:

- ▶: Start playing.
- ◀◀: Return to the beginning of the current (or previous) track.
- ▶▶: Skip to the beginning of the next track.
- : Stop playing or recording.
- ||: Pause playing. To resume, press ▶.
- 1 – 10/0, +10: Select a track number directly.
  - For track number 5, press 5.
  - For track number 15, press +10, then 5.
  - For track number 20, press +10, then 10/0.
  - For track number 30, press +10, +10, then 10/0.
- REC PAUSE: Enter recording pause by pressing this button. To start recording again, press this button then ▶.

### Cassette deck

After pressing TAPE/CDR (or TAPE/CDR CONTROL), you can perform the following operations on a cassette deck:

- ▶: Start playing.
- REW: Fast wind the tape from right to left.
- FF: Fast wind the tape from left to right.
- : Stop playing or recording.
- ||: Pause playing. To resume, press ▶.
- REC PAUSE: Enter recording pause by pressing this button. To start recording again, press this button then ▶.

### Note:

You can use either the TAPE/CDR or the TAPE/CDR CONTROL button to activate the buttons for the target source. If you press the TAPE/CDR button, the playing source also changes. On the other hand, pressing the TAPE/CDR CONTROL button does not change the playing source.

## Operating Video Components

### IMPORTANT:

To operate JVC's video components using the supplied remote control:

- You need to connect JVC's video components through the AV COMPU LINK jacks (see page 39) in addition to the connections using cables with RCA pin plugs (see pages 11 and 12).
- Some JVC's VCRs can accept two types of the control signals—remote code "A" and "B." Before using this remote control, make sure that the remote control code of the target VCR is set to code "A."
- When using the remote control, aim the remote control directly at the remote sensor on each component, not on the receiver.

### VCR

You can always perform the following operations:

VCR  $\odot/\text{I}$ : Turn on or off a VCR.

After pressing VCR (or VCR CONTROL), you can perform the following operations on a VCR:

- 1 – 9, 0: Select the TV channels on a VCR.
- ▶: Start playing.
- REW: Rewind a tape.
- FF: Fast wind a tape.
- : Stop playing or recording.
- ||: Pause playing. To resume, press ▶.
- REC PAUSE: Enter recording pause by pressing this button. To start recording again, press this button then ▶.
- CH +/-: Change the TV channels on the VCR.

### Note:

You can use either the VCR or the VCR CONTROL button to activate the buttons listed above. If you press the VCR button, the playing source also changes. On the other hand, pressing the VCR CONTROL button does not change the playing source.

### DVD player

After pressing DVD or DVD MULTI, you can perform the following operations on a DVD player:

- ▶: Start playing.
- ◀◀: Return to the beginning of the current (or previous) chapter.
- ▶▶: Skip to the beginning of the next chapter.
- : Stop playing.
- ||: Pause playing. To resume, press ▶.

After pressing DVD or DVD MULTI, these buttons can be used for the DVD menu operations.

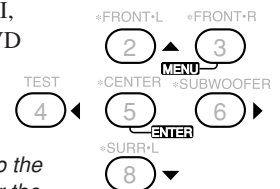

### Note:

For detailed menu operations, refer to the instructions supplied with the discs or the DVD player.

### TV

You can always perform the following operations:

- TV  $\odot/\text{I}$ : Turn on or off the TV.
- TV VOL +/-: Adjust the volume.
- TV/VIDEO: Set the input mode (either TV or VIDEO).

After pressing TV/DBS, you can perform the following operations on a TV:

- CH +/-: Change the channels.
- 1 – 9, 0, 100+: Select the channels.
- RETURN: Alternate between the previously selected channel and the current channel.

# Operating Other Manufacturers' Video Equipment—

This remote control supplied with the receiver can transmit control signals for other manufacturers' TVs, CATV converters, DBS tuners, VCRs and DVD players.

When operating the other manufacturers' components, refer also to the manuals supplied with them.

- After replacing batteries for the remote control, you need to set the manufactures' codes again.

## To change the transmittable signals for operating another manufacturer's TV

1. Press and hold TV  $\phi$ /I.
2. Press TV/DBS.
3. Enter a manufacturer's code using buttons 1 – 9, and 0.

See the list on the right column to find the code.

4. Release TV  $\phi$ /I.

The following buttons can be used for operating a TV:

- TV  $\phi$ /I: Turn on and off the TV.  
 TV VOL +/-: Adjust the volume.  
 TV/VIDEO: Set the input mode (either TV or VIDEO).

After pressing TV/DBS, you can perform the following operations on a TV:

- CH +/-: Change the channels.  
 1 – 10/0, 0, 100+ (+10):  
 Select the channels.  
 The 10/0 button will function as the ENTER button if your TV requires pressing ENTER after selecting a channel number.

### Notes:

- All the functions listed above may not be assigned to the buttons for some TVs.
- If you cannot change the channels of some TVs by pressing 10 keys, press CH +/- for changing the channels.

5. Try to operate your TV by pressing TV  $\phi$ /I.

When your TV turns on or off, you have entered the correct code.

If there are more than one code listed for your brand of TV, try each one until the correct one is entered.

## For TV

Manufacturer	Codes	Manufacturer	Codes
JVC	00*, 02, 13, 14, 47, 74	Quelle	52, 53, 54, 55, 56, 57, 58, 59, 60, 61, 62, 63, 64, 65, 66, 67
Akai	01, 02	RCA/ Proscan	08, 24, 29, 30, 31, 48
Blaupunkt	03, 04		
Fisher	01, 05	SABA	32, 33, 68, 69, 70
Grundig	03, 06, 07	Samsung	06, 08, 16, 34, 35, 49
Hitachi	08, 09, 10, 49		
Irradio	02	Sanyo	01, 05
ITT/NOKIA	11, 12	Schneider	02, 15, 36
Loewe	06, 15, 16	Sharp	37, 38, 77
Magnavox	08, 17, 49	Sony	39
Mets	50, 51, 52, 53	Telefunken	40, 41, 42, 69
Mitsubishi	08, 18, 19, 20	Thomson	71, 72
Mivar	21	Toshiba	37, 43, 44
Nordmende	22, 23	Zenith	45, 46
Okano	15		
Panasonic	24, 25, 26, 27, 76		
Philips	15, 17, 28, 75		

\*Initial setting

Manufacturers' codes are subject to change without notice. If they are changed, this remote control cannot operate the equipment.

**To change the transmittable signals for operating a CATV converter or DBS tuner**

1. Press and hold CATV/DBS  $\phi/\lambda$ .
2. Press CATV/DBS CONTROL.
3. Enter a manufacturer's code using buttons 1 – 9, and 0.

See the list on the right column to find the code.

4. Release CATV/DBS  $\phi/\lambda$ .

The following buttons can be used for operating a CATV converter and DBS tuner:

CATV/DBS  $\phi/\lambda$ : Turn on and off a CATV converter or DBS tuner.

After pressing CATV/DBS CONTROL, you can perform the following operations on a CATV converter or DBS tuner:

- CH +/-: Change the channels.  
 1 – 10/0, 0, 100+ (+10): Select the channels.  
 The 10/0 button will function as the ENTER button if your equipment requires pressing ENTER after selecting a channel number.

5. Try to operate your CATV converter or DBS tuner by pressing CATV/DBS  $\phi/\lambda$ .

When your CATV converter or DBS tuner turns on or off, you have entered the correct code.

**If there are more than one code listed for your brand of CATV converter or DBS tuner, try each one until the correct one is entered.**

**Note:**

*You cannot preset the signals for both the CATV converter and DBS tuner at the same time.*

**For DBS tuner**

Manufacturer	Codes
JVC	56*, 57, 67
Amstrad	43, 44, 45, 46, 47, 48, 49
Blaupunkt	30
Echostar	50, 51, 67
Goldstar	31
Grundig	32, 33
Hirshmann	48, 52, 53, 54, 55
Instrument	68
ITT/NOKIA	34
Kathrein	52, 58, 59, 60, 61, 62, 63
NEC	35, 36
Orbitech	48
Philips	37, 38
RCA	65
Samsung	39, 40
Schwaiger	61, 64
Siemens	41, 42
Sony	66
Technisat	48

\*Initial setting

**For CATV converter**

Manufacturer	Codes
General Instrument	06, 07, 08, 09, 10, 11, 12, 13, 14, 29
Hamlin/Regal	01, 02, 03, 04, 05
Jerrold	06, 07, 08, 09, 10, 11, 12, 13, 14
Oak	15, 16, 17
Panasonic	18, 19, 20
Pioneer	21, 22
Scientific Atlanta	23, 24, 25
Tocom	26
Zenith	27, 28

Manufacturers' codes are subject to change without notice. If they are changed, this remote control cannot operate the equipment.



## To change the transmittable signals for operating another manufacturer's VCR

1. Press and hold VCR  $\phi/I$ .
2. Press VCR.
3. Enter manufacturer's code using buttons 1–9, and 0.

See the list on the right column to find the code.

4. Release VCR  $\phi/I$ .

The following buttons can be used for operating a VCR:

VCR  $\phi/I$ : Turn on and off a VCR.

After pressing VCR, you can perform the following operations on a VCR:

CH +/-: Change the TV channels on a VCR.

1 – 10/0, 0, 100+ (+10):

Select the TV channels.

The 10/0 button will function as the ENTER button if your VCR requires pressing ENTER after selecting a channel number.

▶: Start playback.

REW: Rewind a tape.

FF: Fast wind a tape.

■: Stop playing or recording.

||: Pause playing. To resume, press ▶.

REC PAUSE: Enter recording pause by pressing this button. To start recording again, press this button then ▶.

5. Try to operate your VCR by pressing VCR  $\phi/I$ .

When your VCR turns on or off, you have entered the correct code.

If there are more than one code listed for your brand of VCR, try each one until the correct one is entered.

## For VCR

Manufacturer	Codes
JVC	00*, 26, 27, 28, 29, 58
Aiwa	01, 02
Bell & Howell	03
Blaupunkt	04, 05
CGM	06, 07
Emerson	08, 10, 11, 12, 64, 65
Fisher	03, 14, 15, 16, 17
Funai	01
GE	18, 19, 20
Goldstar	07
Goodmans	13, 21
Grundig	06, 22
Hitachi	18, 23, 24, 25, 66
Loewe	07, 21
Magnavox	04, 19, 24
Mitsubishi	30, 31, 32, 33, 34, 35
NEC	26, 27
Nokia	03, 36
Nordmende	38
Orion	09
Panasonic	19, 24, 39, 40
Philips	04, 19, 21, 24, 41, 42
Phonola	21
RCA/Proscan	04, 18, 19, 23, 24, 43, 44, 45
SABA	38, 46
Samsung	45, 47, 59, 61, 62, 63
Sanyo	03, 48, 49
Sharp	37, 50
Siemens	03, 51
Sony	52, 53, 54
Telefunken	55, 60
Toshiba	43, 44
Zenith	56, 57

\*Initial setting

Manufacturers' codes are subject to change without notice. If they are changed, this remote control cannot operate the equipment.

**To change the transmittable signals for operating another manufacturer's DVD player**

1. Press and hold AUDIO  $\phi/I$ .
- 2 Press DVD.
3. Enter a manufacturer's code using buttons 1-9, and 0.

See the list on the right column to find the code.

**4. Release AUDIO  $\phi/I$ .**

After pressing DVD or DVD MULTI, you can perform the following operations on a DVD player:

- ▶: Start playing.
- ◀◀: Return to the beginning of the current (or previous) chapter.
- ▶▶: Skip to the beginning of the next chapter.
- : Stop playing.
- ⏸: Pause playing. To resume, press ▶.

After pressing DVD or DVD MULTI, these buttons can be used for the DVD menu operations.

**Note:**  
For detailed menu operations, refer to the instructions supplied with the discs or the DVD player.

**5. Try to operate your DVD player by pressing one of the above buttons.**

- DO NOT forget to turn on a DVD player before pressing one of the above buttons.

**If there are more than one code listed for your brand of DVD, try each one until the correct one is entered.**

For DVD player



Manufacturer	Codes
JVC	00*, 02
Denon	01
Panasonic	03
Philips	13
Pioneer	04, 05, 06
RCA	07
Samsung	08
Sony	09
Toshiba	10
Yamaha	11, 12

\*Initial setting

Manufacturers' codes are subject to change without notice. If they are changed, this remote control cannot operate the equipment.

# Troubleshooting

Use this chart to help you solve daily operational problems. If there is any problem you cannot solve, contact your JVC's service center.

PROBLEM	POSSIBLE CAUSE	SOLUTION
The display does not light up.	The power cord is not plugged in.	Plug the power cord into an AC outlet.
No sound from speakers.	Speaker signal cables are not connected.	Check speaker wiring and reconnect if necessary. (See pages 9 and 10.)
	The SPEAKERS ON/OFF 1 and SPEAKERS ON/OFF 2 buttons are not set correctly.	Press SPEAKERS ON/OFF 1 and SPEAKERS ON/OFF 2 correctly. (See page 17.)
	An incorrect source is selected.	Select the correct source.
	Muting is activated.	Press MUTING to cancel the mute. (See page 20.)
	An incorrect input mode (analog or digital) is selected.	Select the correct input mode (analog or digital). (See page 17.)
Sound from one speaker only.	Speaker signal cables are not connected properly.	Check speaker wiring and reconnect if necessary. (See pages 9 and 10.)
Continuous hiss or buzzing during FM reception.	Incoming signal is too weak.	Connect an outdoor FM antenna or contact your dealer. (See page 8.)
	The station is too far away.	Select a new station.
	An incorrect antenna is used.	Check with your dealer to be sure you have the correct antenna.
Noise is heard during FM/AM reception.	Antennas are not connected properly.	Check connections. (See page 8.)
	Ignition noise from automobiles.	Move the antenna farther from automobile traffic.
No sound effect such as Surround mode, DSP mode and Digital Equalization.	Analog Direct is turned on.	Turn off Analog Direct. (See page 19.)
	DVD MULTI is selected as the source.	Select the source other than DVD MULTI.
EX/ES (7.1-channel) reproduction cannot be done for Dolby Digital EX or DTS ES software.	Software or setting is not for Dolby Digital EX or DTS ES software.	Play back software bearing the mark  or  . Set "EX/ES" setting to "ON." (See page 35.)
"OVERLOAD" starts flashing on the display.	Speakers are overloaded because of high volume.	<ol style="list-style-type: none"> <li>1. Press  STANDBY/ON on the front panel to turn off the receiver.</li> <li>2. Stop the playback source.</li> <li>3. Turn on the receiver again, and adjust the volume.</li> </ol>
	Speakers are overloaded because of short circuit of speaker terminals.	Press  STANDBY/ON on the front panel to turn off the receiver, then check the speaker wiring. If "OVERLOAD" does not disappear, unplug the AC power cord, then plug it back again. If speaker wiring is not short-circuited, contact your dealer.
The STANDBY lamp lights up after turning on the power, and soon the receiver turns off again (into standby mode).	The receiver is overloaded because of a high voltage.	Press  STANDBY/ON on the front panel to turn off the receiver. After unplugging the AC power cord, consult your dealer.
Remote control does not work.	There is an obstruction between the remote sensor on the receiver and the remote control.	Remove the obstruction.
	Batteries are weak.	Replace batteries. (See page 7.)
Remote control does not work as you intend.	An incorrect remote control operation mode is selected.	Select the correct remote control operation mode. (See pages 42 to 48.)

# Specifications

## Amplifier

### Output Power

#### At Stereo operation

Front ch: 100 W per channel, min. RMS, driven into 8  $\Omega$ , 1 kHz, with no more than 0.8% total harmonic distortion. (IEC268-3/DIN)

#### At Surround operation:

Front ch: 100 W per channel, min. RMS, driven into 8  $\Omega$  at 1 kHz, with no more than 0.8% total harmonic distortion.

Center ch: 100 W, min. RMS, driven into 8  $\Omega$  at 1 kHz, with no more than 0.8% total harmonic distortion.

Surround ch: 100 W per channel, min. RMS, driven into 8  $\Omega$  at 1 kHz, with no more than 0.8% total harmonic distortion.

Surround Back ch: 100 W, min. RMS, driven into 8  $\Omega$  at 1 kHz, with no more than 0.8% total harmonic distortion.

## Audio

### Audio Input Sensitivity/Impedance (1 kHz)

DVD IN, VCR IN, TV SOUND/DBS IN: 200 mV/47 k $\Omega$

CD IN, TAPE/CDR IN: 200 mV/47 k $\Omega$

### Audio Input (DIGITAL IN)\*

Coaxial: DIGITAL 1 (DVD): 0.5 V(p-p)/75  $\Omega$

Optical: DIGITAL 2 (CD), DIGITAL 3 (TV), DIGITAL 4 (CDR):  
-21 dBm to -15 dBm (660 nm  $\pm$ 30 nm)

\* Corresponding to Linear PCM, Dolby Digital, and DTS Digital Surround (with sampling frequency — 32 kHz, 44.1 kHz, 48 kHz).

Audio Output Level: SUBWOOFER OUT: 1 V

Recording Output Level: VCR OUT, TAPE/CDR OUT: 200 mV

Digital output: Optical: DIGITAL OUT  
Signal wave length: 660 nm  
Output level: -21 dBm to -15 dBm

### Signal-to-Noise Ratio ('66 IHF/DIN)

DVD IN, VCR IN, TV SOUND/DBS IN: 87 dB/67 dB

CD IN, TAPE/CDR IN: 87 dB/67 dB

### Frequency Response (8 $\Omega$ )

DVD IN, VCR IN, TV SOUND/DBS IN:  
20 Hz to 100 kHz (+1 dB, -3 dB)

CD IN, TAPE/CDR IN: 20 Hz to 100 kHz (+1 dB, -3 dB)

### Equalization (5 bands):

63 Hz, 250 Hz, 1 kHz, 4 kHz, 16 kHz ( $\pm$ 8 dB)

Bass boost: +6 dB  $\pm$ 1.0 dB at 100 Hz

## Video

### Video Input Sensitivity/Impedance

Composite video: DVD IN, VCR IN, TV SOUND/DBS IN:

1 V(p-p)/75  $\Omega$

S-video: DVD IN, VCR IN, TV SOUND/DBS IN:

(Y: luminance): 1 V(p-p)/75  $\Omega$

(C: chrominance, burst): 0.286 V(p-p)/75  $\Omega$

Component video: DVD IN, DBS IN:

(Y: luminance): 1 V(p-p)/75  $\Omega$

(Pb/Pr): 0.7 V(p-p)/75  $\Omega$

### Video Output Level

Composite video: VCR OUT, MONITOR OUT: 1 V(p-p)/75  $\Omega$

S-video: VCR OUT, MONITOR OUT:

(Y: luminance): 1 V(p-p)/75  $\Omega$

(C: chrominance, burst): 0.286 V(p-p)/75  $\Omega$

Component video: MONITOR OUT

(Y: luminance): 1 V(p-p)/75  $\Omega$

(Pb/Pr): 0.7 V(p-p)/75  $\Omega$

### Synchronization:

Signal-to-Noise Ratio: Negative 45 dB

## FM tuner (IHF)

Tuning Range: 87.50 MHz to 108.00 MHz

Usable Sensitivity: Monaural: 12.8 dBf (1.2  $\mu$ V/75  $\Omega$ )

50 dB Quieting Sensitivity: Monaural: 16.0 dBf (1.7  $\mu$ V/75  $\Omega$ )

Stereo: 37.5 dBf (20.5  $\mu$ V/75  $\Omega$ )

Stereo Separation at REC OUT: 35 dB at 1 kHz

## AM tuner

Tuning Range: 522 kHz to 1 629 kHz

## General

Power Requirements: AC 240 V  $\sim$ , 50 Hz

Power Consumption: 250 W (at operation)

4.5 W (in standby mode)

Dimensions (W x H x D): 435 mm x 157 mm x 425 mm

Mass: 12.2 kg

Designs & specifications are subject to change without notice.

RX-7032VSL

AUDIO/VIDEO CONTROL RECEIVER



## Free Manuals Download Website

<http://myh66.com>

<http://usermanuals.us>

<http://www.somanuals.com>

<http://www.4manuals.cc>

<http://www.manual-lib.com>

<http://www.404manual.com>

<http://www.luxmanual.com>

<http://aubethermostatmanual.com>

Golf course search by state

<http://golfingnear.com>

Email search by domain

<http://emailbydomain.com>

Auto manuals search

<http://auto.somanuals.com>

TV manuals search

<http://tv.somanuals.com>